

RECORD OF SURVEY FOR
RICHARD CROOKS

LOT 19, CEDAR MOUNTAIN NO. 6-A SUBDIVISION
 SECTIONS 17 and 20, TOWNSHIP 3 SOUTH, RANGE 8 WEST
 UINTAH SPECIAL BASE AND MERIDIAN

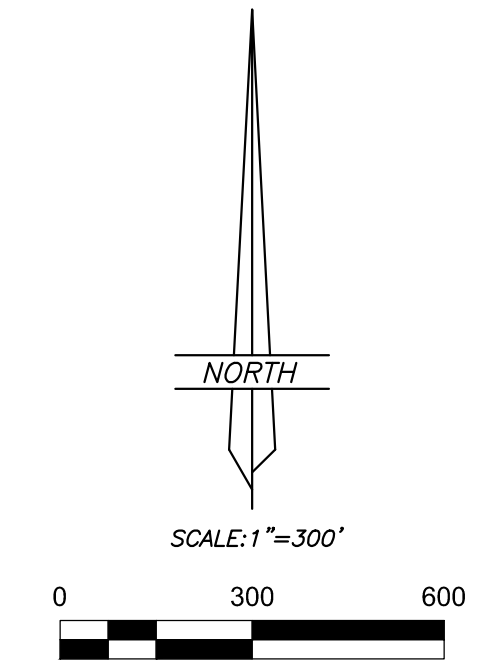

LEGEND AND NOTES

- FOUND SECTION CORNERS AS NOTED ON PLAT
- FOUND QUARTER CORNERS AS NOTED ON PLAT
- SET 5/8"x24" REBAR WITH CAP STAMPED "ALLRED SURVEYING" AT CORNERS
- SET SPIKE WITH "WHISKERS" ON RIGHT-OF-WAY LINE
- FOUND ORIGINAL 2X2 HUBS
- FOUND CONCRETE POSTS
- FOUND IRON PIN
- FOUND "T" POST
- FOUND OLD CEDAR POST AT CORNER

THIS SURVEY WAS PERFORMED USING GLOBAL POSITIONING SYSTEM (G.P.S.) EQUIPMENT AND PROCEDURES USING THE UTAH G.P.S. VIRTUAL REFERENCE STATION CONTROL NETWORK MAINTAINED AND OPERATED BY THE UTAH GEOOSPITAL RESOURCE CENTER. THE BASIS OF BEARINGS IS GEODETIC NORTH DERIVED FROM G.P.S. OBSERVATIONS AT A CONTROL POINT LOCATED AT LAT: 40°11'44.89846" N & LONG: 110°49'41.53893" W USING SAID CONTROL NETWORK.

NARRATIVE

This survey was performed at the request of Richard Crooks in order to locate on the ground the corners for Lot 19, CEDAR MOUNTAIN NO. 6-A Subdivision as shown on this plat. A search was made to locate the monuments marking the lot corners of the subdivision. The results are noted on the plat and the found monuments were used to control the survey.

SURVEYOR'S CERTIFICATE

I, Jerry D. Allred, do hereby certify that I am a Professional Land Surveyor, and that I hold certificate no. 148951 as prescribed by the laws of the State of Utah. I further certify that this plat and its computations were prepared from the field notes and electronic data collector files of an actual survey made by me, or under my personal supervision, of the parcels of land shown hereon, and that the monuments indicated were found or set during said survey, and that this plat accurately represents said survey to the best of my knowledge.

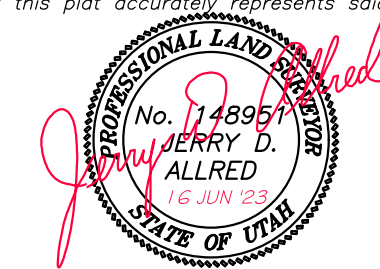

JERRY D. ALLRED, PROFESSIONAL LAND SURVEYOR
 CERTIFICATE NO. 148951 (UTAH)

COUNTY SURVEYOR FILE NO. 5503

JERRY D. ALLRED & ASSOCIATES, INC.
 SURVEYING CONSULTANTS
 1235 NORTH 700 EAST--P.O. BOX 975
 DUCHESNE, UTAH 84021
 (435) 738-5352

