

RECORD OF SURVEY FOR THE BARBARA SWASEY MINOR SUBDIVISION SECTION 35, T3S, R4W, U.S.B.&M. DUCHESE COUNTY, UTAH

LINE	BEARING	DISTANCE
L1	N 78°36'38" W	42.41'
L2	S 10°56'40" W	115.73'
L3	S 79°3'20" E	94.00'
L4	S 10°56'28" W	115.00'
L5	S 53°42'15" W	73.33'
L6	N 00°00'22" W	176.74'
L7	S 80°49'13" E	58.78'
L8	S 28°03'10" W	142.97'
L9	N 61°58'50" W	87.56'
L10	N 28°03'10" E	57.85'
L11	N 80°49'13" W	75.82'
L12	S 28°03'10" W	366.31'
L13	N 79°03'20" W	34.45'

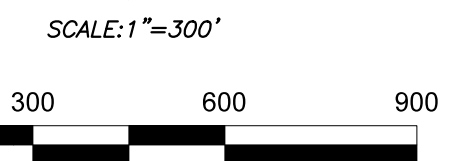
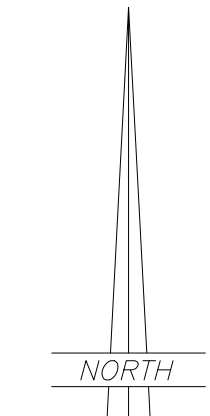

- LEGEND**
- FOUND OR SET SECTION CORNER AS NOTED ON PLAT
 - FOUND OR SET QUARTER CORNER AS NOTED ON PLAT
 - ◇ FOUND OR SET 1/16 CORNER AS NOTED ON PLAT
 - FOUND MONUMENT SET BY OTHERS
 - SET 5/8"x24" REBAR WITH PLASTIC CAP STAMPED "ALLRED SURVEY"
 - ▽ 8" SPIKES WITH "WHISKERS" SET ON LINE
 - FENCE CORNER
 - X — EXISTING FENCE
 - ① NOTE NUMBER
 - ◆ FOUND HIGHWAY RIGHT-OF-WAY MARKER

BASIS OF BEARINGS

THIS SURVEY WAS PERFORMED USING GLOBAL POSITIONING SYSTEM (G.P.S.) EQUIPMENT AND PROCEDURES USING THE UTAH G.P.S. VIRTUAL REFERENCE STATION CONTROL NETWORK MAINTAINED AND OPERATED BY THE UTAH GEOSPATIAL RESOURCE CENTER. THE BASIS OF BEARINGS IS GEODETIC NORTH DERIVED FROM G.P.S. OBSERVATIONS AT A CONTROL POINT (SECTION CORNER) LOCATED AT LAT: 40°09'16.01931" N & LONG: 110°45'51.61780" W USING SAID CONTROL NETWORK.

NARRATIVE

This survey was performed at the request of Barbara Swasey for the purpose of creating a minor subdivision of the parcel of land shown on this plat. Section 35 was originally surveyed by the General Land Office in 1882 using the "3-mile method" of section subdivision during which the sixteenth corners were set. The boundary of the section was remonumented in 1904 during a dependent resurvey. A search was made for the monuments marking the Public Land Survey System corners and the results are noted on the plat. The highway right-of-way monuments indicated on the plat were found and used to define the right-of-way lines of the highway. The PLSS and highway monuments were used to control the survey. This survey represents a dependent resurvey of Section 35 using the "3 mile method" of section subdivision and is designed to restore the corners in their true original locations according to the best available evidence.

NOTES

① The highway curves were calculated from the positional data using the found right-of-way monuments rather than bearings and distances shown on the highway plats. The plat data does not fit the ground data precisely so the monumented data was used as control. There was also discovered a discrepancy in the stationing on the plats which did not fit the ground data.

DESCRIPTION OF BOUNDARY

Beginning at the Northeast Corner of the Southeast Quarter of the Northeast Quarter of Section 35, township 3 South, Range 4 West of the Utah Special Base and Meridian; Thence South 00°11'25" East 1305.24 feet to the Northeast Corner of the Northeast Quarter of the Southeast Quarter of said Section; Thence South 00°11'25" East 166.87 feet along the East line of said aliquot part to the North right-of-way line of Old U.S. Highway 40; Thence North 78°36'38" West 946.35 feet along said right-of-way line; Thence North 10°56'40" East 115.73 feet; Thence North 79°03'20" West 94.00 feet; Thence South 10°56'28" West 115.00 feet to said right-of-way line; Thence North 78°36'38" West 317.87 feet along said right-of-way line to the West line of said Southeast Quarter of said Northeast Quarter; Thence North 00°11'30" West 1199.37 feet to the Northeast Corner of said aliquot part; Thence North 89°48'20" East 1330.61 feet along the North line of said aliquot part to the Point of Beginning, containing 40.553 acres.

SURVEYOR'S CERTIFICATE

I, Jerry D. Allred, do hereby certify that I am a Professional Land Surveyor, and that I hold certificate no. 148951 as prescribed by the laws of the State of Utah. I further certify that this plat and its computations were prepared from the field notes and electronic data collector files of an actual survey made by me, or under my personal supervision, of the parcels of land shown hereon, and that the monuments indicated were found or set during said survey, and that this survey represents said survey to the best of my knowledge.

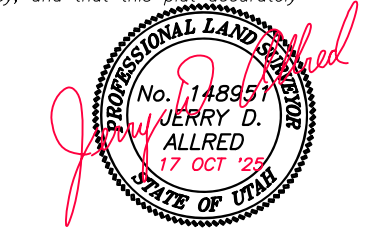

JERRY D. ALLRED, PROFESSIONAL LAND SURVEYOR
CERTIFICATE NO. 148951 (UTAH)

OWNER'S CERTIFICATE

I, BARBARA M. SWASEY, Trustee of the JOHN A. SWASEY AND BARBARA W. SWASEY REVOCABLE TRUST, dated September, 2005, the undersigned, owner of the parcels of land shown hereon, having caused the same to be subdivided into the lots as shown, do hereby set apart the same as a minor subdivision, and place the boundary lines of the lots and easements as shown and described on this plat.

Landowner's Signatures: _____ Date Acknowledged: _____
Notary Initials: _____

BARBARA M. SWASEY, Trustee of the JOHN A. SWASEY AND BARBARA W. SWASEY REVOCABLE TRUST, dated September, 2005

ACKNOWLEDGMENT

State of Utah } SS
County of _____ }
On the date shown by the signature, personally appeared before me, BARBARA M. SWASEY, Trustee of the JOHN A. SWASEY AND BARBARA W. SWASEY REVOCABLE TRUSTS, dated September, 2005, the signer of the above certificate who duly acknowledged to me that she did execute same.
My commission expires _____ Notary Public

DUCHESE COUNTY TREASURER

PROPERTY TAX CLEARANCE
THIS _____ DAY OF _____ OF 20____

DUCHESE COUNTY TREASURER

DUCHESE COUNTY PLANNING DEPARTMENT APPROVAL

APPROVED AS A MINOR SUBDIVISION ON
THIS _____ DAY OF _____ OF 20____
DUCHESE COUNTY COMMUNITY DEVELOPMENT DIRECTOR

COUNTY RECORDER'S CERTIFICATE

STATE OF UTAH } SS
COUNTY OF DUCHESE }
THIS IS TO CERTIFY THAT THIS PLAT WAS FILED FOR RECORD IN THE COUNTY RECORDER'S OFFICE ON THE _____ DAY OF _____, 20____, AT _____ O'CLOCK _____ M, AND IS DULY RECORDED.
FILING NO. _____
COUNTY RECORDER

COUNTY SURVEYOR FILE NO. 6033

JERRY D. ALLRED & ASSOCIATES, INC.
SURVEYING CONSULTANTS
1235 NORTH 700 EAST—P.O. BOX 975
DUCHESE, UTAH 84021
(435) 738-5352