

LEGEND

- ⊙ POWER POLE
- ⋈ ANCHOR GUY
- ⚡ EP ENERGY SIGN
- EXISTING PIPELINE
- DP—DP— OVERHEAD POWER

BASIS OF BEARINGS

THIS SURVEY WAS PERFORMED USING GLOBAL POSITIONING SYSTEM PROCEDURES AND EQUIPMENT

THE BASIS OF BEARINGS IS GEODETIC NORTH DERIVED FROM G.P.S. OBSERVATIONS AT THE SECTION CORNER LOCATED AT LAT. 40°15'22.90258"N AND LONG. 110°23'21.19760"W USING THE UTAH STATE G.P.S. VIRTUAL REFERENCE STATION CONTROL NETWORK MAINTAINED AND OPERATED BY THE AUTOMATED GEOGRAPHIC REFERENCE CENTER

SURVEYOR'S CERTIFICATE

I, D. RYAN ALLRED, DUCHESNE COUNTY, UTAH, DO HEREBY CERTIFY THAT THIS PLAT WAS PREPARED FROM THE FIELD NOTES AND ELECTRONIC DATA COLLECTOR FILES OF AN ACTUAL SURVEY MADE BY ME OR UNDER MY PERSONAL SUPERVISION AND THAT THE MONUMENTS INDICATED WERE FOUND OR SET DURING SAID SURVEY, AND THAT THIS PLAT ACCURATELY REPRESENTS SAID SURVEY TO THE BEST OF MY KNOWLEDGE AND BELIEF.

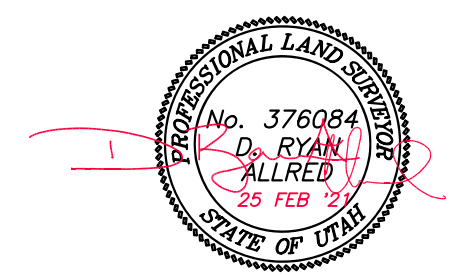

D. Ryan Allred, Professional Land Surveyor, Certificate No. 376084, (Utah)

RIGHT-OF-WAY SURVEY FOR

KINDER MORGAN

EP ENERGY SWD15C4 CONNECTOR

SECTION 15,
TOWNSHIP 3 SOUTH, RANGE 4 WEST
UINTAH SPECIAL BASE & MERIDIAN
DUCHESNE COUNTY, UTAH

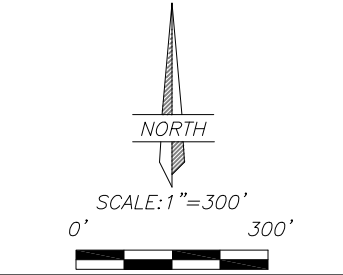

PAGE 1 OF 2 25 FEB 2021 12-121-593

JERRY D. ALLRED & ASSOCIATES, INC.
SURVEYING CONSULTANTS

1235 NORTH 700 EAST--P.O. BOX 975
DUCHESNE, UTAH 84021
(435) 738-5352

DESCRIPTION OF RIGHT-OF-WAY CORRIDOR

A 40' wide right-of-way over portions of Section 15, Township 3 South, Range 4 West, Uintah Special Base and Meridian, the widths being 20 feet on each side of the following described centerline, TOGETHER with a 30 feet wide temporary right-of-way running adjacent to and along the left side of said described centerline as follows;
 Commencing at the Northeast Corner of the NE1/4 of the SE1/4 of said Section 15;
 Thence South 88°07'15" West 1121.46 feet along the North line of said aliquot part;
 Thence South 00°00'00" East 1028.85 feet to the TRUE POINT OF BEGINNING;
 Thence South 65°48'33" East 176.68 feet to an existing pipeline. Said described right-of-way being 176.68 feet in length, with the sidelines being shortened or elongated to intersect existing right-of-way lines.

DESCRIPTION OF 50'X50' RIGHT-OF-WAY

Commencing at the Northeast Corner of the NE1/4 of the SE1/4 of Section 15, Township 3 South, Range 4 West, Uintah Special Base and Meridian;
 Thence South 88°07'15" West 1154.80 feet along the North line of said aliquot part;
 Thence South 00°00'00" East 979.90 feet to the TRUE POINT OF BEGINNING which is on the Easterly line of an Ep Energy E&P Company, LP. surface use right-of-way;
 Thence South 65°48'12" East 50.00 feet;
 Thence South 24°11'27" West 49.99 feet to an existing right-of-way line;
 Thence North 65°48'33" West 50.00 feet along said right-of-way line to said surface use right-of-way line;
 Thence North 24°11'27" East 50.00 feet along said surface use right-of-way line to said TRUE POINT OF BEGINNING, containing 0.057 acres.

TOTAL LENGTHS

NAME	SN:	DISTANCE (FEET)	DISTANCE (RODS)
EP ENERGY	3095-1	176.68	10.708

BASIS OF BEARINGS

THIS SURVEY WAS PERFORMED USING GLOBAL POSITIONING SYSTEM PROCEDURES AND EQUIPMENT

THE BASIS OF BEARINGS IS GEODETIC NORTH DERIVED FROM G.P.S. OBSERVATIONS AT THE SECTION CORNER LOCATED AT LAT. 40°15'22.90258"N AND LONG. 110°23'21.19760"W USING THE UTAH STATE G.P.S. VIRTUAL REFERENCE STATION CONTROL NETWORK MAINTAINED AND OPERATED BY THE AUTOMATED GEOGRAPHIC REFERENCE CENTER

SURVEYOR'S CERTIFICATE

I, D. RYAN ALLRED, DUCHESNE COUNTY, UTAH, DO HEREBY CERTIFY THAT THIS PLAT WAS PREPARED FROM THE FIELD NOTES AND ELECTRONIC DATA COLLECTOR FILES OF AN ACTUAL SURVEY MADE BY ME OR UNDER MY PERSONAL SUPERVISION AND THAT THE MONUMENTS INDICATED WERE FOUND OR SET DURING SAID SURVEY, AND THAT THIS PLAT ACCURATELY REPRESENTS SAID SURVEY TO THE BEST OF MY KNOWLEDGE AND BELIEF.

RIGHT-OF-WAY SURVEY FOR

KINDER MORGAN

EP ENERGY SWD15C4 CONNECTOR

SECTION 15,
 TOWNSHIP 3 SOUTH, RANGE 4 WEST
 UINTAH SPECIAL BASE & MERIDIAN
 DUCHESNE COUNTY, UTAH

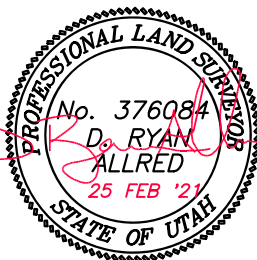

PAGE 2 OF 2 25 FEB 2021 12-121-593

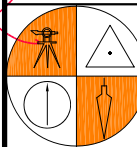

JERRY D. ALLRED & ASSOCIATES, INC.
 SURVEYING CONSULTANTS

1235 NORTH 700 EAST--P.O. BOX 975
 DUCHESNE, UTAH 84021
 (435) 738-5352