

SEC 6 SEC 5
SEC 7 SEC 8

BASIS OF BEARINGS

THIS SURVEY WAS PERFORMED USING GLOBAL POSITIONING SYSTEM PROCEDURES AND EQUIPMENT

THE BASIS OF BEARINGS IS GEODETIC NORTH DERIVED FROM G.P.S. OBSERVATIONS AT THE SECTION CORNER LOCATED AT LAT. 40°15'22.90258"N AND LONG. 110°23'21.19760"W USING THE UTAH STATE G.P.S. VIRTUAL REFERENCE STATION CONTROL NETWORK MAINTAINED AND OPERATED BY THE AUTOMATED GEOGRAPHIC REFERENCE CENTER

RIGHT-OF-WAY OF SURVEY
FOR

KINDER MORGAN

**C4 COMPRESSOR SITE PIPELINE
UVR 8-1**

SECTION 8, TOWNSHIP 3 SOUTH, RANGE 4 WEST
UINTAH SPECIAL BASE & MERIDIAN
DUCHESNE COUNTY, UTAH

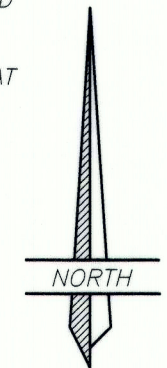

SCALE: 1" = 100'

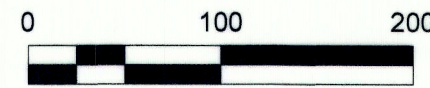

N 00°06'17" W 2629.04'

SW1/4
NW1/4

LINE TABLE

LINE	BEARING	DISTANCE
L1	S 00°01'51" E	16.97'
L2	S 89°49'37" E	117.14'
L3	N 88°59'21" E	159.90'
L4	N 89°54'54" E	38.61'
L5	N 00°11'38" W	17.87'
L6	S 89°22'44" W	315.60'

DESCRIPTION OF RIGHT-OF-WAY

Beginning at the Northwest Corner of the NW1/4 of the SW1/4 of Section 8, Township 3 South, Range 4 West, Uintah Special Base and Meridian; Thence South 00°01'51" East 16.97 feet along the West line of said aliquot part to the North line of an existing pipeline right-of-way; Thence South 89°49'37" East 117.14 feet along said North line; Thence North 88°59'21" East 159.90 feet along said North line; Thence North 89°54'54" East 38.61 feet along said North line; Thence North 00°11'38" West 17.87 feet to the North line of said aliquot part; Thence South 89°22'44" West 315.60 feet to the POINT OF BEGINNING, containing 0.130 acres.

SURVEYOR'S CERTIFICATE

I, D. RYAN ALLRED, DUCHESNE COUNTY, UTAH, DO HEREBY CERTIFY THAT I AM A PROFESSIONAL LAND SURVEYOR AND THAT I HOLD CERTIFICATE NUMBER 376084 AS PRESCRIBED BY THE STATE OF UTAH. I FURTHER CERTIFY THAT THIS PLAT WAS PREPARED FROM THE FIELD NOTES AND ELECTRONIC DATA COLLECTOR FILES OF AN ACTUAL SURVEY MADE BY ME OR UNDER MY PERSONAL SUPERVISION AND THAT THE MONUMENTS INDICATED WERE FOUND OR SET DURING SAID SURVEY, AND THAT THIS PLAT ACCURATELY REPRESENTS SAID SURVEY TO THE BEST OF MY KNOWLEDGE AND BELIEF.

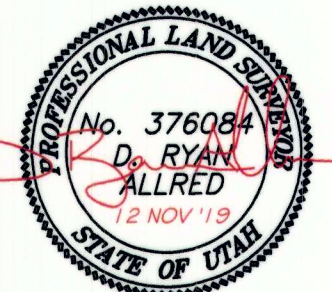

D. Ryan Allred, Professional Land Surveyor,
Certificate No. 376084, (Utah)

EP ENERGY RIGHT-OF-WAY

40'

FOUND G.L.O. STEEL PIPE AND BRASS CAP AT 1/4 CORNER

P.O.B.

FOUND G.L.O. STEEL PIPE AND BRASS CAP AT 1/4 CORNER



0.13 Acres

N 89°22'44" E 5336.58'

EXISTING "KOCH PIPELINE" RIGHT-OF-WAY

FOUND 5/8" REBAR WITH ALUMINUM CAP NORTH 3.07' OF LOT CORNER

**MWR
PROPERTY
UVR-8-1**

S 00°01'51" E 2629.41'

S 00°09'57" E 1310.50'

COUNTY SURVEYOR'S FILE # 4362 1 of 3

JERRY D. ALLRED & ASSOCIATES, INC.
SURVEYING CONSULTANTS
1235 NORTH 700 EAST--P.O. BOX 975
DUCHESNE, UTAH 84021
(435) 738-5352

SEC 6 SEC 5
SEC 7 SEC 8

BASIS OF BEARINGS

THIS SURVEY WAS PERFORMED USING GLOBAL POSITIONING SYSTEM PROCEDURES AND EQUIPMENT

THE BASIS OF BEARINGS IS GEODETIC NORTH DERIVED FROM G.P.S. OBSERVATIONS AT THE SECTION CORNER LOCATED AT LAT. 40°15'22.90258"N AND LONG. 110°23'21.19760"W USING THE UTAH STATE G.P.S. VIRTUAL REFERENCE STATION CONTROL NETWORK MAINTAINED AND OPERATED BY THE AUTOMATED GEOGRAPHIC REFERENCE CENTER

N 00°06'17" W 2629.04'

SW1/4
NW1/4

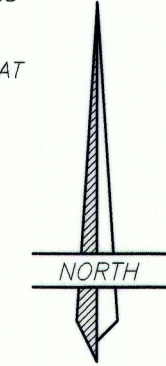

SCALE: 1" = 100'

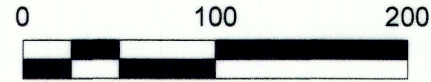

RIGHT-OF-WAY OF SURVEY
FOR
KINDER MORGAN
C4 COMPRESSOR SITE PIPELINE
UVR 8-2

SECTION 8, TOWNSHIP 3 SOUTH, RANGE 4 WEST
UINTAH SPECIAL BASE & MERIDIAN
DUCHESNE COUNTY, UTAH

DESCRIPTION OF RIGHT-OF-WAY

Commencing at the Northwest Corner of the NW1/4 of the SW1/4 of Section 8, Township 3 South, Range 4 West, Uintah Special Base and Meridian;
Thence North 89°22'44" East 315.61 feet along the North line of said aliquot part to the TRUE POINT OF BEGINNING which is on the East line of Lot 8-2 Uintah View Ranches Subdivision;
Thence South 00°09'56" East 17.87 feet along the West line of said Lot 8-2 to the North line of an existing right-of-way;
Thence North 89°54'54" East 196.75 feet along said North line;
Thence North 00°00'00" West 19.71 feet to said aliquot part line;
Thence South 89°22'44" West 196.82 feet to the TRUE POINT OF BEGINNING, containing 0.084 acres.

SURVEYOR'S CERTIFICATE

I, D. RYAN ALLRED, DUCHESNE COUNTY, UTAH, DO HEREBY CERTIFY THAT I AM A PROFESSIONAL LAND SURVEYOR AND THAT I HOLD CERTIFICATE NUMBER 376084 AS PRESCRIBED BY THE STATE OF UTAH. I FURTHER CERTIFY THAT THIS PLAT WAS PREPARED FROM THE FIELD NOTES AND ELECTRONIC DATA COLLECTOR FILES OF AN ACTUAL SURVEY MADE BY ME OR UNDER MY PERSONAL SUPERVISION AND THAT THE MONUMENTS INDICATED WERE FOUND OR SET DURING SAID SURVEY, AND THAT THIS PLAT ACCURATELY REPRESENTS SAID SURVEY TO THE BEST OF MY KNOWLEDGE AND BELIEF.

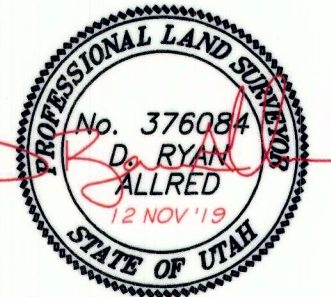

D. Ryan Allred, Professional Land Surveyor,
Certificate No. 376084, (Utah)

EP ENERGY RIGHT-OF-WAY

40'

FOUND G.L.O. STEEL PIPE AND BRASS CAP AT 1/4 CORNER

FOUND G.L.O. STEEL PIPE AND BRASS CAP AT 1/4 CORNER

315.61'

N 89°22'44" E 5336.58'

T.P.O.B. 196.82'

EXISTING "KOCH PIPELINE" RIGHT-OF-WAY

N 89°54'54" E 196.75'

0.08 Acres

N 00°00'00" W 19.71'

S 00°09'56" E 17.87'

FOUND 5/8" REBAR WITH ALUMINUM CAP NORTH 3.07' OF LOT CORNER

UVR-8-2

S 00°01'51" E 2629.41'

S 00°09'57" E 1310.50'

NW1/4 SW1/4

COUNTY SURVEYOR'S FILE # 4362.2 of 3

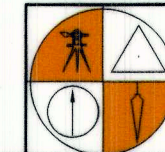

JERRY D. ALLRED & ASSOCIATES, INC.
SURVEYING CONSULTANTS

1235 NORTH 700 EAST--P.O. BOX 975
DUCHESNE, UTAH 84021
(435) 738-5352

12 NOV 2019

12-121-520

SEC 6 SEC 5
SEC 7 SEC 8

BASIS OF BEARINGS

THIS SURVEY WAS PERFORMED USING GLOBAL POSITIONING SYSTEM PROCEDURES AND EQUIPMENT

THE BASIS OF BEARINGS IS GEODETIC NORTH DERIVED FROM G.P.S. OBSERVATIONS AT THE SECTION CORNER LOCATED AT LAT. 40°15'22.90258"N AND LONG. 110°23'21.19760"W USING THE UTAH STATE G.P.S. VIRTUAL REFERENCE STATION CONTROL NETWORK MAINTAINED AND OPERATED BY THE AUTOMATED GEOGRAPHIC REFERENCE CENTER

RIGHT-OF-WAY OF SURVEY
FOR

KINDER MORGAN

**C4 COMPRESSOR SITE PIPELINE
MWR 3068**

SECTION 8, TOWNSHIP 3 SOUTH, RANGE 4 WEST
UINTAH SPECIAL BASE & MERIDIAN
DUCHESNE COUNTY, UTAH

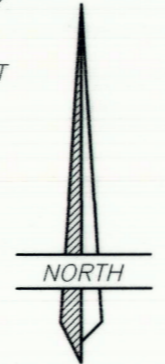

SCALE: 1" = 100'

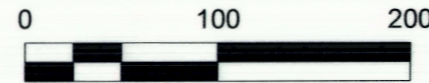

N 00°06'17" W 2629.04'

SW1/4
NW1/4

DESCRIPTION OF RIGHT-OF-WAY

Beginning at the Southwest Corner of the SW1/4 of the NW1/4 of Section 8, Township 3 South, Range 4 West, Uintah Special Base and Meridian;
Thence North 89°22'44" East 512.42 feet along the South line of said aliquot part;
Thence North 00°00'00" West 40.00 feet;
Thence South 89°22'44" West 512.50 feet to the East line of said aliquot part;
Thence South 00°06'17" East 40.00 feet to the POINT OF BEGINNING, containing 0.471 acres.

SURVEYOR'S CERTIFICATE

I, D. RYAN ALLRED, DUCHESNE COUNTY, UTAH, DO HEREBY CERTIFY THAT I AM A PROFESSIONAL LAND SURVEYOR AND THAT I HOLD CERTIFICATE NUMBER 376084 AS PRESCRIBED BY THE STATE OF UTAH. I FURTHER CERTIFY THAT THIS PLAT WAS PREPARED FROM THE FIELD NOTES AND ELECTRONIC DATA COLLECTOR FILES OF AN ACTUAL SURVEY MADE BY ME OR UNDER MY PERSONAL SUPERVISION AND THAT THE MONUMENTS INDICATED WERE FOUND OR SET DURING SAID SURVEY, AND THAT THIS PLAT ACCURATELY REPRESENTS SAID SURVEY TO THE BEST OF MY KNOWLEDGE AND BELIEF.

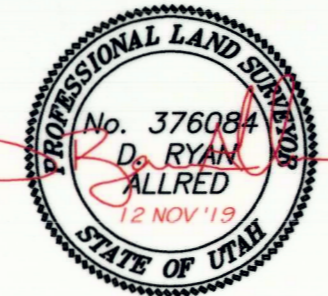

D. Ryan Allred, Professional Land Surveyor,
Certificate No. 376084, (Utah)

EP ENERGY RIGHT-OF-WAY

MWR
PROPERTY
3068

N 00°00'00" W 40.00'
FOUND G.L.O. STEEL PIPE AND BRASS CAP AT 1/4 CORNER

S 89°22'44" W 512.50'

512.43'

N 89°22'44" E

5336.58'

EXISTING "KOCH PIPELINE"
RIGHT-OF-WAY

FOUND 5/8" REBAR WITH ALUMINUM CAP
NORTH 3.07' OF LOT CORNER

FOUND G.L.O. STEEL PIPE AND BRASS CAP AT 1/4 CORNER

P.O.B.

S 00°01'51" E 2629.41'

S 00°09'57" E 1310.50'

COUNTY SURVEYOR'S FILE # 4362.3 of 3



JERRY D. ALLRED & ASSOCIATES, INC.

SURVEYING CONSULTANTS

1235 NORTH 700 EAST--P.O. BOX 975
DUCHESNE, UTAH 84021
(435) 738-5352

12 NOV 2019

12-121-520