

RIGHT-OF-WAY OF SURVEY FOR INTEGRATED WATER MANAGEMENT SECTIONS 29, 30, 31 & 32, TOWNSHIP 2 SOUTH, RANGE 4 WEST & SECTION 6, TOWNSHIP 3 SOUTH, RANGE 4 WEST UINTAH SPECIAL BASE AND MERIDIAN DUCHESE COUNTY, UTAH

FOUND DUCHESE COUNTY MONUMENT AT SECTION CORNER SEC 30
SEC 31
SEC 25
SEC 36
FOUND DUCHESE COUNTY MONUMENT AT CLOSING QUARTER CORNER N 89°48'50" W 0.04 FEET FROM CORNER

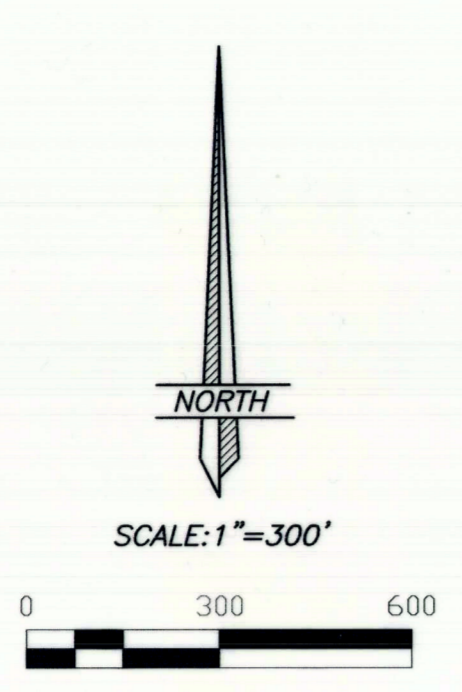

LEGEND AND NOTES

- FOUND MONUMENT AT SECTION CORNER
 - FOUND MONUMENT AT QUARTER CORNER
 - FOUND REBAR AT 1/16 CORNER
- THIS SURVEY WAS PERFORMED USING GLOBAL POSITIONING SYSTEM PROCEDURES AND EQUIPMENT THE BASIS OF BEARINGS IS GEODETIC NORTH DERIVED FROM G.P.S. OBSERVATIONS AT THE TOWNSHIP CORNER LOCATED AT LAT. 40°15'22.90267"N AND LONG. 110°23'21.19828"W USING THE UTAH STATE G.P.S. VIRTUAL REFERENCE STATION CONTROL NETWORK MAINTAINED AND OPERATED BY THE AUTOMATED GEOGRAPHIC REFERENCE CENTER

DESCRIPTION OF RIGHT-OF-WAY
A 30 feet wide pipeline right-of-way over portions of Sections 30 & 31 of Township 2 South, Range 4 West and Section 6, of Township 3 South, Range 4 West of the Uintah Special Base and Meridian. Said right-of-way being 15 feet on each side of the following described centerline:
Commencing at the Southeast Corner of said Section 30;
Thence North 42°17'28" West 612.02 feet to the TRUE POINT OF BEGINNING;
Thence South 84°18'55" East 179.34 feet;
Thence South 76°39'39" East 255.43 feet;
Thence South 00°01'34" West 376.02 feet;
Thence South 00°08'29" East 1374.88 feet;
Thence North 89°44'41" West 67.00 feet;
Thence North 75°20'17" West 99.57 feet;
Thence South 89°54'15" West 755.60 feet;
Thence South 61°45'21" West 379.39 feet;
Thence South 00°08'29" East 1181.47 feet;
Thence North 89°32'12" West 481.71 feet;
Thence South 01°22'04" West 1246.37 feet;
Thence North 89°23'48" West 291.59 feet;
Thence South 00°07'41" East 1476.87 feet;
Thence South 00°40'14" West 1743.85 feet;
Thence South 09°01'26" East 403.40 feet to an existing oil well location pad. Said described centerline being 10312.48 feet in length, with the sidelines being shortened or elongated to intersect said location pad.

LINE TABLE

LINE	BEARING	DISTANCE
L1	S 84°18'55" E	179.34
L2	S 76°39'39" E	255.43
L3	S 00°01'34" W	376.02
L4	S 00°08'29" E	1374.88
L5	N 89°44'41" W	67.00
L6	N 75°20'17" W	99.57
L7	S 89°54'15" W	755.60
L8	S 61°45'21" W	379.39
L9	S 00°08'29" E	1181.47
L10	N 89°32'12" W	481.71
L11	S 01°22'04" W	1246.37
L12	N 89°23'48" W	291.59
L13	S 00°07'41" E	1476.87
L14	S 00°40'14" W	1743.85
L15	S 09°01'26" E	403.40

FOUND GAL PIPE AND CAP WITH STONE ALONGSIDE AT QUARTER CORNER

1318.60'
1531.55'
N 00°00'31" E 2850.15'
N 00°00'31" E 2850.15'

SEC 36
SEC 31
SEC 1
SEC 6
FOUND G.L.O. CAP AND PIPE MONUMENT AT SECTION CORNER

N 00°05'30" E 2827.54'

N 89°54'07" E 2659.28'
N 00°00'22" W 1328.27'
N 00°00'22" W 1328.27'
N 00°00'22" W 1328.27'
N 00°00'22" W 1328.27'

S 89°58'12" E 2661.52'

SURVEYOR'S CERTIFICATE
I, D. RYAN ALLRED, DUCHESE COUNTY, UTAH, DO HEREBY CERTIFY THAT I AM A PROFESSIONAL LAND SURVEYOR AND THAT I HOLD CERTIFICATE NUMBER 376084 AS PRESCRIBED BY THE STATE OF UTAH. I FURTHER CERTIFY THAT THIS PLAT WAS PREPARED FROM THE FIELD NOTES AND ELECTRONIC DATA COLLECTOR FILES OF AN ACTUAL TOPOGRAPHIC SURVEY MADE BY ME OR UNDER MY PERSONAL SUPERVISION AND THAT THIS PLAT ACCURATELY REPRESENTS SAID SURVEY TO THE BEST OF MY KNOWLEDGE AND BELIEF.

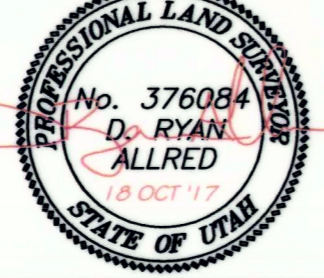

D. Ryan Allred, Professional Land Surveyor, Certificate 376084 (Utah)

EXISTING EP ENERGY RIGHT-OF-WAY

IWM W/1/2 LOT 6 22.61 Acres

THORNE E/1/2 LOT 6

IWM NW/1/4 NE/1/4

IWM SW/1/4 NE/1/4

SET 5/8"x24" REBAR WITH CAP STAMPED 148951

FOUND G.L.O. CAP AND PIPE MONUMENT AT QUARTER CORNER

FOUND DUCHESE COUNTY MONUMENT AT CLOSING QUARTER CORNER N 00°08'21" W 0.04 FEET FROM CORNER

FOUND DUCHESE COUNTY MONUMENT AT QUARTER CORNER

FOUND DUCHESE COUNTY MONUMENT AT SECTION CORNER

FOUND DUCHESE COUNTY MONUMENT AT QUARTER CORNER

FOUND G.L.O. CAP AND PIPE MONUMENT AT QUARTER CORNER

FOUND G.L.O. CAP AND PIPE MONUMENT AT QUARTER CORNER

FOUND DUCHESE COUNTY MONUMENT AT SECTION CORNER

SEC 30
SEC 29
SEC 31
SEC 32
N 89°57'10" W 2639.02'
N 89°57'10" W 2639.02'
N 89°57'10" W 2639.02'
N 89°57'10" W 2639.02'
N 89°57'10" W 2639.02'

FOUND DUCHESE COUNTY MONUMENT AT SECTION CORNER

WINTEROSE
NW/1/4 NE/1/4
NW/1/4 NE/1/4
NW/1/4 NE/1/4

DUCHESENASATCH BLUEBENCH LANDFILL
DUCHESENASATCH BLUEBENCH LANDFILL
DUCHESENASATCH BLUEBENCH LANDFILL

PROPOSE 30' WIDE PIPELINE RIGHT-OF-WAY

PROPOSE 30' WIDE PIPELINE RIGHT-OF-WAY

PROPOSE 30' WIDE PIPELINE RIGHT-OF-WAY

PROPOSE 30' WIDE PIPELINE RIGHT-OF-WAY

PROPOSE 30' WIDE PIPELINE RIGHT-OF-WAY

PROPOSE 30' WIDE PIPELINE RIGHT-OF-WAY

PROPOSE 30' WIDE PIPELINE RIGHT-OF-WAY

PROPOSE 30' WIDE PIPELINE RIGHT-OF-WAY

PROPOSE 30' WIDE PIPELINE RIGHT-OF-WAY

PROPOSE 30' WIDE PIPELINE RIGHT-OF-WAY

PROPOSE 30' WIDE PIPELINE RIGHT-OF-WAY

PROPOSE 30' WIDE PIPELINE RIGHT-OF-WAY

PROPOSE 30' WIDE PIPELINE RIGHT-OF-WAY

PROPOSE 30' WIDE PIPELINE RIGHT-OF-WAY

PROPOSE 30' WIDE PIPELINE RIGHT-OF-WAY

PROPOSE 30' WIDE PIPELINE RIGHT-OF-WAY

PROPOSE 30' WIDE PIPELINE RIGHT-OF-WAY