

RIGHT-OF-WAY SURVEY FOR
KINDER MORGAN

S.R.87/S.R.35
 SECTION 6, TOWNSHIP 3 SOUTH, RANGE 4 WEST
 UTAH SPECIAL BASE AND MERIDIAN
 DUCHESNE COUNTY, UTAH

DESCRIPTION

Commencing at the West 1/4 Corner of Section 6, Township 3 South, Range 4 West, of the Uintah Special Base and Meridian;
 Thence South 68°03'44" East 588.14 feet to the TRUE POINT OF BEGINNING, which is on the North line of an existing pipeline right-of-way;
 Thence North 33°03'45" East 30.00 feet perpendicular from said North right-of-way line;
 Thence South 57°10'50" East 90.00 feet parallel with said North right-of-way line to the West right-of-way line of S.R. 87;
 Thence South 11°17'57" West 32.25 feet along said West right-of-way line to said North right-of-way line;
 Thence North 57°10'50" West 101.96 feet along said North right-of-way line to the TRUE POINT OF BEGINNING, containing 0.07 acres.
 With a Basis of Bearings to be North 00°05'38" West between the Southwest Corner and said West 1/4 Corner of said Section 6.

BASIS OF BEARINGS

THIS SURVEY WAS PERFORMED USING GLOBAL POSITIONING SYSTEM PROCEDURES AND EQUIPMENT

THE BASIS OF BEARINGS IS GEODETIC NORTH DERIVED FROM G.P.S. OBSERVATIONS AT THE SECTION CORNER LOCATED AT LAT. 40°15'22.90258"N AND LONG. 110°23'21.19760"W USING THE UTAH STATE G.P.S. VIRTUAL REFERENCE STATION CONTROL NETWORK MAINTAINED AND OPERATED BY THE AUTOMATED GEOGRAPHIC REFERENCE CENTER

SURVEYOR'S CERTIFICATE

I, D. RYAN ALLRED, DUCHESNE COUNTY, UTAH, DO HEREBY CERTIFY THAT I AM A PROFESSIONAL LAND SURVEYOR AND THAT I HOLD CERTIFICATE NUMBER 376084 AS PRESCRIBED BY THE STATE OF UTAH. I FURTHER CERTIFY THAT THIS PLAT WAS PREPARED FROM THE FIELD NOTES AND ELECTRONIC DATA COLLECTOR FILES OF AN ACTUAL SURVEY MADE BY ME OR UNDER MY PERSONAL SUPERVISION AND THAT THE MONUMENTS INDICATED WERE FOUND OR SET DURING SAID SURVEY, AND THAT THIS PLAT ACCURATELY REPRESENTS SAID SURVEY TO THE BEST OF MY KNOWLEDGE AND BELIEF.

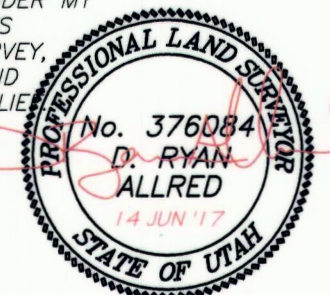

D. Ryan Allred, Professional Land Surveyor,
 Certificate 376084 (Utah)

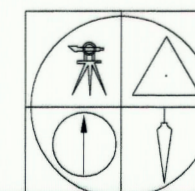

JERRY D. ALLRED & ASSOCIATES, INC.
 SURVEYING CONSULTANTS

1235 NORTH 700 EAST--P.O. BOX 975
 DUCHESNE, UTAH 84021
 (435) 738-5352

REV 14 JUN 2017
 10 APR 2017 12-121-380

SEC 36 SEC 31
 SEC 1 SEC 6

FOUND G.L.O.
 BRASS CAP
 AT SECTION
 CORNER

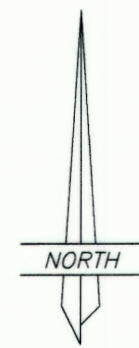

SCALE: 1"=200'

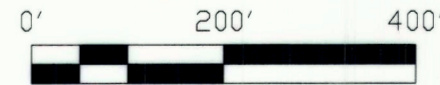

N 00°05'31" E 2627.60'

HIGHWAY RIGHT-OF-WAY
 S.R. 87
 HIGHWAY RIGHT-OF-WAY

EXISTING PIPELINE
 (WITHIN UDOT ROW)

S.R. 87

S 89°58'12" E 5309.24'

FOUND
 COPPERWELD
 AT 1/4
 CORNER

EXISTING PIPELINE RIGHT-OF-WAY

PROPOSED
 (0.07) Acs.

S 68°03'44" E 588.14'



MILE MARKER 6

S.R. 35

EXISTING PIPELINE RIGHT-OF-WAY
 CHEVRON PIPELINES

LINE	BEARING	DISTANCE
L1	N 33°03'45" E	30.00'
L2	S 57°10'50" E	90.00'
L3	S 11°17'57" W	32.25'
L4	N 57°10'50" W	101.96'

NW 1/4
 SW 1/4

SN: 3052 & 3053

S 00°05'38" W 2632.68'

FOUND G.L.O.
 BRASS CAP AT
 SECTION
 CORNER

SEC 1 SEC 6
 SEC 12 SEC 7