

PROPERTY SURVEY FOR
EP ENERGY E&P COMPANY, LLC
 SECTION 21, TOWNSHIP 3 SOUTH, RANGE 4 WEST
 UINTAH SPECIAL BASE AND MERIDIAN

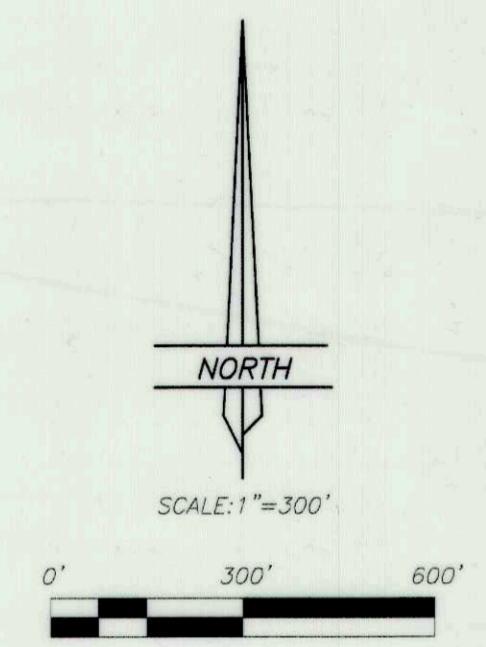

LEGEND AND NOTES

- 3/4"x24" REBAR WITH PLASTIC CAP STAMPED LS 148951 SET ON LOT LINE INTERSECTION WITH COUNTY ROAD RIGHT-OF-WAY LINE
 - ▲ FOUND REBAR AT ORIGINAL LOT CORNERS
 - G.L.O. U.S. GENERAL LAND OFFICE, ORIGINAL FEDERAL SURVEYORS OF PUBLIC LANDS
- N:30891.97
E:66018.06 LOCAL COORDINATES OF FOUND AND CONTROLLING CORNERS

THE REBAR LOT CORNERS FOUND ON THE EXTERIOR OF THE SECTION ARE NOT GENERALLY ON THE SECTION LINES AND ARE TO BE USED AS CLOSING CORNERS FOR THEIR RESPECTIVE LOTS.

THIS SURVEY WAS PERFORMED USING GLOBAL POSITIONING SYSTEM PROCEDURES AND EQUIPMENT

THE BASIS OF BEARINGS IS GEODETIC NORTH DERIVED FROM G.P.S. OBSERVATIONS AT THE SECTION CORNER LOCATED AT LAT. 40°15'22.90258"N AND LONG. 110°23'21.19760"W USING THE UTAH STATE G.P.S. VIRTUAL REFERENCE STATION CONTROL NETWORK MAINTAINED AND OPERATED BY THE AUTOMATED GEOGRAPHIC REFERENCE CENTER

NARRATIVE

This survey was performed at the request of EP Energy E&P Company, LLC for the purpose of setting the corners of the Yeates parcels shown. The monuments marking the Public Land Survey System corners as well as several property corners were found as indicated and used to control this survey. Section 21 has been subdivided and several of the rebar marking those corners were found.

SURVEYOR'S CERTIFICATE

This is to certify that this plat was prepared from the field notes and electronic data collector files of an actual survey made by me, or under my personal supervision, of the parcels shown hereon, and that the monuments indicated were found or set during said survey, and that this plat accurately represents said survey to the best of my knowledge.

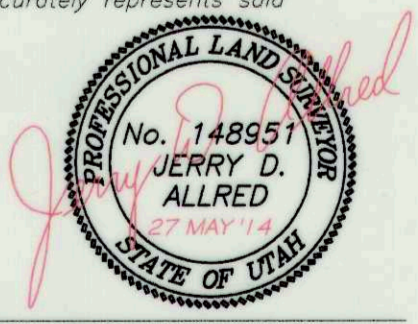

Jerry D. Allred, Professional Land Surveyor,
 Certificate 148951 (Utah)

COUNTY SURVEYOR'S FILE NO. 3045

JERRY D. ALLRED & ASSOCIATES
 SURVEYING CONSULTANTS
 1235 NORTH 700 EAST - P.O. BOX 975
 DUCHESNE, UTAH 84021
 (435) 735-5352