

PIPELINE CORRIDOR RIGHT-OF-WAY SURVEY FOR
EP ENERGY E&P COMPANY
 PENFIELD 2-10C4
 SECTION 10, TOWNSHIP 3 SOUTH, RANGE 4 WEST
 UTAH SPECIAL BASE AND MERIDIAN
 DUCHESNE COUNTY, UTAH

PIPELINE CORRIDOR RIGHT-OF-WAY DESCRIPTION

A 40 feet wide pipeline corridor right-of-way over portions of Section 10, Township 3 South, Range 4 West of the Uintah Special Base and Meridian, the centerline of said right-of-way being further described as follows:
 Commencing at the Northeast Corner of said Section 10;
 Thence South 24°32'03" West 1314.51 feet to the TRUE POINT OF BEGINNING, said point being on the East line of the EP Energy E&P Co. Penfield 2-10C4 well location use area;
 Thence South 65°08'35" East 576.92 feet;
 Thence South 00°05'38" West 1179.59 feet;
 Thence South 00°06'21" West 397.48 feet to an existing pipeline. Said right-of-way being 2153.99 feet in length with the sidelines being shortened or elongated to intersect said pipeline and use area boundary.

SURVEYOR'S CERTIFICATE

This is to certify that this plat was prepared from the field notes and electronic data collector files of an actual survey made by me, or under my personal supervision, of the pipeline corridor right-of-way shown hereon, and that the monuments indicated were found or set during said survey, and that this plat accurately represents said survey to the best of my knowledge.

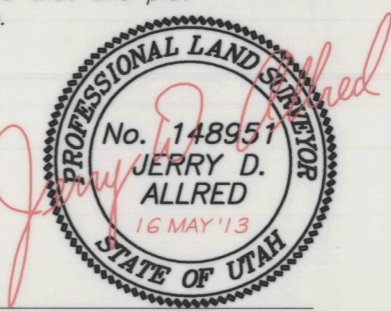

Jerry D. Allred, Professional Land Surveyor,
 Certificate 148951 (Utah)

THIS SURVEY WAS PERFORMED USING GLOBAL POSITIONING SYSTEM PROCEDURES AND EQUIPMENT
 THE BASIS OF BEARINGS IS GEODETIC NORTH DERIVED FROM G.P.S. OBSERVATIONS AT THE SECTION CORNER LOCATED AT LAT. 40°15'22.90258"N AND LONG. 110°23'21.19760"W USING THE UTAH STATE G.P.S. VIRTUAL REFERENCE STATION CONTROL NETWORK MAINTAINED AND OPERATED BY THE AUTOMATED GEOGRAPHIC REFERENCE CENTER

16 MAY 2013 01-128-403

County Surveyor File # 2816

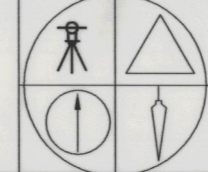

JERRY D. ALLRED AND ASSOCIATES
 SURVEYING CONSULTANTS

1235 NORTH 700 EAST--P.O. BOX 975
 DUCHESNE, UTAH 84021
 (435) 738-5352