

PIPELINE CENTERLINE DATA

LINE	BEARING	DISTANCE
L1	S 28°54'22" W	384.31
L2	S 44°43'28" W	898.14
L3	S 00°22'14" W	305.99
L4	S 00°20'32" W	513.88
L5	S 24°39'05" E	483.90
L6	S 02°36'16" W	94.69
L7	S 32°24'42" W	37.34
L8	S 03°11'53" W	424.18
L9	S 25°37'38" W	271.11
L10	S 02°51'07" W	424.23
L11	S 09°10'00" W	22.60
L12	S 09°10'00" W	114.14
L13	S 01°21'30" E	1367.91
L14	S 00°55'34" W	270.39
L15	S 24°26'41" E	46.72
L16	S 24°26'41" E	519.17
L17	S 47°54'30" E	490.04
L18	S 07°59'23" E	171.82
L19	S 07°59'23" E	243.10
L20	S 07°59'23" E	243.10
L21	S 40°47'30" E	371.83
L22	S 02°10'15" W	181.84
L23	S 46°48'07" E	308.70
L24	S 43°35'26" E	150.18
L25	S 36°42'28" E	55.53
L26	S 01°45'14" W	157.51
L27	S 89°56'07" E	47.86
L28	S 89°56'11" E	1240.00
L29	S 21°38'13" E	77.56
L30	S 89°28'31" E	44.19
L31	S 89°28'31" E	1254.85
L32	S 00°00'52" W	770.62
L33	S 09°21'56" W	53.31
L34	S 00°15'56" E	441.93
L35	S 00°15'56" E	1264.04
L36	S 72°03'40" E	33.60
L37	S 72°03'40" E	98.82
L38	S 00°15'04" E	1370.52
L39	S 00°15'04" E	1294.15

LINE	BEARING	DISTANCE
L101	S 32°18'40" W	73.78
L102	S 00°48'41" E	70.61
L103	N 88°56'57" E	84.24
L104	N 88°56'57" E	21.82
L105	S 00°04'15" W	644.56
L106	S 15°59'04" E	65.07
L107	S 00°00'48" W	94.99
L108	S 17°06'42" W	68.73
L109	S 00°05'51" E	313.90
L110	S 49°14'36" E	54.52

**LEGEND AND NOTES**

- EXISTING FENCE
- OVERHEAD POWER LINES
- PIPELINE
- ◇ FOUND MONUMENT
- ▬ PAVED SURFACE
- ⊕ POWER POLE

THE PIPELINE SHOWN IS THE CENTERLINE OF A 40 FEET WIDE RIGHT-OF-WAY.

THE BASIS OF BEARINGS IS GEODETIC NORTH DERIVED FROM G.P.S. OBSERVATIONS USING THE UTAH STATE G.P.S. VIRTUAL REFERENCE STATION CONTROL NETWORK MAINTAINED AND OPERATED BY THE AUTOMATED GEOGRAPHIC REFERENCE CENTER.

**PIPELINE RIGHT-OF-WAY CORRIDOR SURVEY FOR  
EL PASO MIDSTREAM  
INVESTMENT COMPANY, LLC  
SOUTH BRANCH--HARVEST PIPELINE  
SECTIONS 21, 27, 28, AND 34, TOWNSHIP 3 SOUTH, RANGE 2 WEST  
UINTAH SPECIAL BASE AND MERIDIAN**

**SURVEYOR'S CERTIFICATE**

This is to certify that this plot was prepared from the field notes and electronic data collector files of an actual survey made by me, or under my personal supervision, of the pipeline corridor right-of-way shown hereon, and that the monuments indicated were found or set during said survey, and that this plot accurately represents said survey to the best of my knowledge.

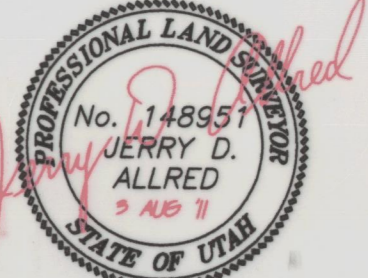

Jerry D. Allred, Professional Land Surveyor,  
Certificate 148951 (Utah)

COUNTY SURVEYOR FILE NO. 2745

**JERRY D. ALLRED & ASSOCIATES**  
SURVEYING CONSULTANTS  
1235 NORTH 700 EAST - P.O. BOX 975  
Duchesne, Utah 84021  
(435) 738-5352