

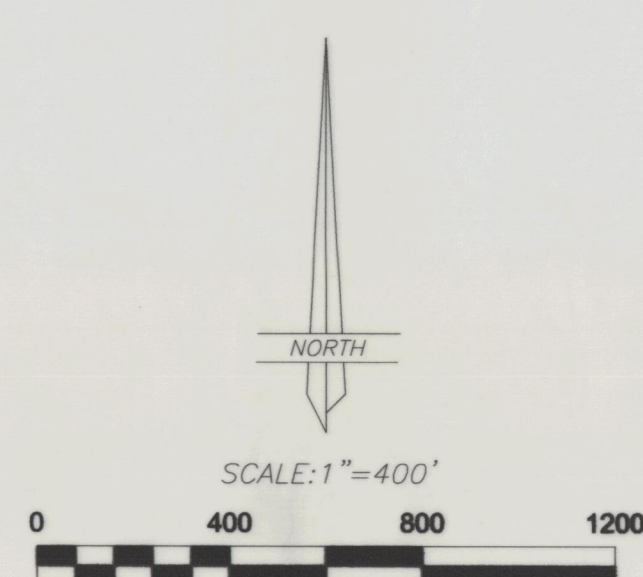

LINE	BEARING	DISTANCE
L1	S 66°00'37" W	31.12'
L2	N 18°31'49" W	53.64'
L3	N 03°27'21" W	19.69'
L4	N 47°00'34" W	1.86'
L5	N 78°48'36" W	84.24'
L6	N 80°09'02" W	127.40'
L7	S 83°36'16" W	92.52'
L8	S 81°28'05" W	54.64'
L9	S 79°56'46" W	68.28'
L10	S 79°27'51" W	155.05'
L11	N 36°24'45" W	111.17'
L12	N 27°41'02" W	22.31'
L13	N 18°22'15" W	141.94'
L14	N 07°01'28" E	166.36'
L15	N 17°41'57" W	29.10'
L16	N 19°30'46" W	116.88'
L17	N 17°38'18" W	449.39'
L18	N 16°14'27" W	106.00'
L19	N 18°03'51" W	123.82'
L20	N 19°51'33" W	116.91'
L21	N 18°34'38" W	140.38'
L22	N 15°18'57" W	48.54'
L23	N 11°14'38" W	62.10'
L24	N 06°53'12" W	52.82'
L25	N 00°07'38" W	48.66'
L26	N 04°23'09" E	143.75'
L27	N 05°48'23" E	123.05'
L28	N 00°56'10" W	40.40'
L29	N 06°25'51" W	58.37'
L30	N 10°09'31" W	70.69'
L31	N 22°03'42" W	16.93'
L32	N 23°53'59" W	32.12'
L33	N 26°29'51" W	74.63'
L34	N 28°58'12" W	34.37'
L35	N 33°33'10" W	20.48'
L36	N 34°32'48" W	126.89'
L37	N 34°12'10" W	98.98'
L38	N 35°52'52" W	222.34'
L39	N 36°33'40" W	91.93'
L40	N 37°04'08" W	98.41'
L41	N 37°46'38" W	56.89'
L42	N 37°11'33" W	31.68'
L43	N 36°55'03" W	76.51'
L44	N 39°31'02" W	79.53'
L45	N 38°33'21" W	34.09'
L46	N 33°23'52" W	11.80'
L47	N 25°53'37" W	150.24'
L48	N 20°26'17" W	21.92'
L49	N 19°41'13" W	21.00'
L50	N 01°45'08" E	90.42'
L51	N 01°59'01" E	79.82'
L52	N 02°18'54" E	44.11'
L53	N 02°27'38" E	40.44'
L54	N 41°49'34" W	68.62'
L55	N 01°03'27" W	82.47'
L56	N 00°21'42" W	142.22'
L57	N 00°19'08" W	193.28'
L58	N 00°59'40" E	127.06'
L59	N 00°25'07" E	192.68'
L60	N 00°12'51" E	94.94'
L61	N 01°01'11" E	102.61'
L62	N 00°22'41" E	160.64'
L63	N 00°38'17" E	30.60'
L64	N 86°48'48" E	20.51'

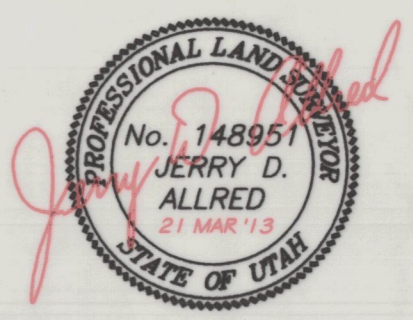

SURVEYOR'S CERTIFICATE
 This is to certify that this plat was prepared from the field notes and electronic data collector files of an actual survey made by me, or under my personal supervision, of the pipeline corridor right-of-way shown hereon, and that the monuments indicated were found or set during said survey, and that this plat accurately represents said survey to the best of my knowledge.



Jerry D. Allred, Professional Land Surveyor,
 Certificate 148951 (Utah)

PIPELINE "AS-BUILT" SURVEY FOR
**EL PASO MIDSTREAM
 INVESTMENT COMPANY, LLC**
BROTHERSON TO CEMETERY PIPELINE
 SECTION 35, TOWNSHIP 1 SOUTH, RANGE 4 WEST
 SECTION 2, TOWNSHIP 2 SOUTH, RANGE 4 WEST
 UINTAH SPECIAL BASE AND MERIDIAN

JERRY D. ALLRED AND ASSOCIATES
 1235 NORTH 300 EAST, P.O. BOX 975
 DUCHESNE, UTAH 84021
 (435) 738-5352

COUNTY SURVEYOR FILE NO.
 21 MAR 2013 12-121-025