

ROAD RIGHT-OF-WAY DESCRIPTION

A 30' WIDE RIGHT-OF-WAY 15' ON EACH SIDE OF THE FOLLOWING DESCRIBED CENTERLINE.

COMMENCING AT THE NORTHWEST CORNER OF SECTION 34, T2S, R3W, U.S.B.&M.; THENCE N89°46'37"E 2637.28' ALONG THE NORTH LINE OF THE NW 1/4 OF SAID SECTION 34 TO THE NORTH 1/4 CORNER OF SAID SECTION 34; THENCE S44°05'10"E 1883.04' TO A POINT ON THE WEST LINE OF THE SE 1/4 NE 1/4 OF SAID SECTION 34 AND THE POINT OF BEGINNING; THENCE S89°53'36"E 88.82'; THENCE S40°33'53"E 27.57'; THENCE S27°41'50"E 147.89' TO A POINT ON THE SOUTH LINE OF THE DESERET GENERATION & TRANSMISSION CO-OPERATIVE EASEMENT IN THE SE 1/4 NE 1/4 OF SAID SECTION 34 AND THE POINT OF TERMINATION, WHICH BEARS N43°39'44"W 1637.40' FROM THE EAST 1/4 CORNER OF SAID SECTION 34. THE SIDE LINES OF SAID DESCRIBED RIGHT-OF-WAY BEING SHORTENED OR ELONGATED TO MEET THE GRANTOR'S PROPERTY LINES. CONTAINS 0.182 ACRES MORE OR LESS.

POINT OF BEGINNING BEARS S44°05'10"E 1883.04' FROM THE NORTH 1/4 CORNER OF SECTION 34, T2S, R3W, U.S.B.&M.

POINT OF TERMINATION BEARS N43°39'44"W 1637.40' FROM THE EAST 1/4 CORNER OF SECTION 34, T2S, R3W, U.S.B.&M.

LINE	DIRECTION	LENGTH
L12	S89°53'36"E	88.82'
L13	S40°33'53"E	27.57'
L14	S26°46'30"E	147.89'
L15	S26°46'30"E	23.00'
L16	S89°47'56"E	382.14'
L17	S00°04'40"W	560.06'
L18	S86°19'22"W	324.13'
L19	N66°50'00"W	235.09'
L20	N00°10'17"W	490.26'
L21	S89°47'56"E	159.69'

ACREAGE / LENGTH TABLE		
FEET	RODS	ACRES
264.28	16.02	0.182

ACREAGE/LENGTH TABLE			
ROAD RIGHT-OF-WAY INSIDE OF DG&T EASEMENT	FEET	RODS	ACRES
	264.28	16.02	0.140

▲ = SECTION CORNERS LOCATED.



CERTIFICATE

THIS IS TO CERTIFY THAT THE ABOVE PLAT WAS PREPARED FROM FIELD NOTES OF ACTUAL SURVEYS MADE BY ME OR UNDER MY SUPERVISION AND THAT THE SAME ARE TRUE AND CORRECT TO THE BEST OF MY KNOWLEDGE AND BELIEF.

Wendell R. Benthon
 REGISTERED LAND SURVEYOR
 REGISTRATION NO. 6631032
 STATE OF UTAH 2012-21

Sheet 1 of 2

REV: 5 04-30-21 L.K. (UPDATE LINE TAGS)

XCL ASSETCO., LLC

**NELSON 34-2D-23 PAD
 ON BRAD LEE NELSON CO TRUSTEE LANDS IN
 SECTION 34, T2S, R3W, U.S.B.&M.
 DUCHESNE COUNTY, UTAH**

SURVEYED BY	C.R.	01-28-21	SCALE
DRAWN BY	S.K.	02-01-21	1" = 500'
FILE	X-1417-C1		

ACCESS ROAD R-O-W & SUA



UELS, LLC
 Corporate Office * 85 South 200 East
 Vernal, UT 84078 * (435) 789-1017

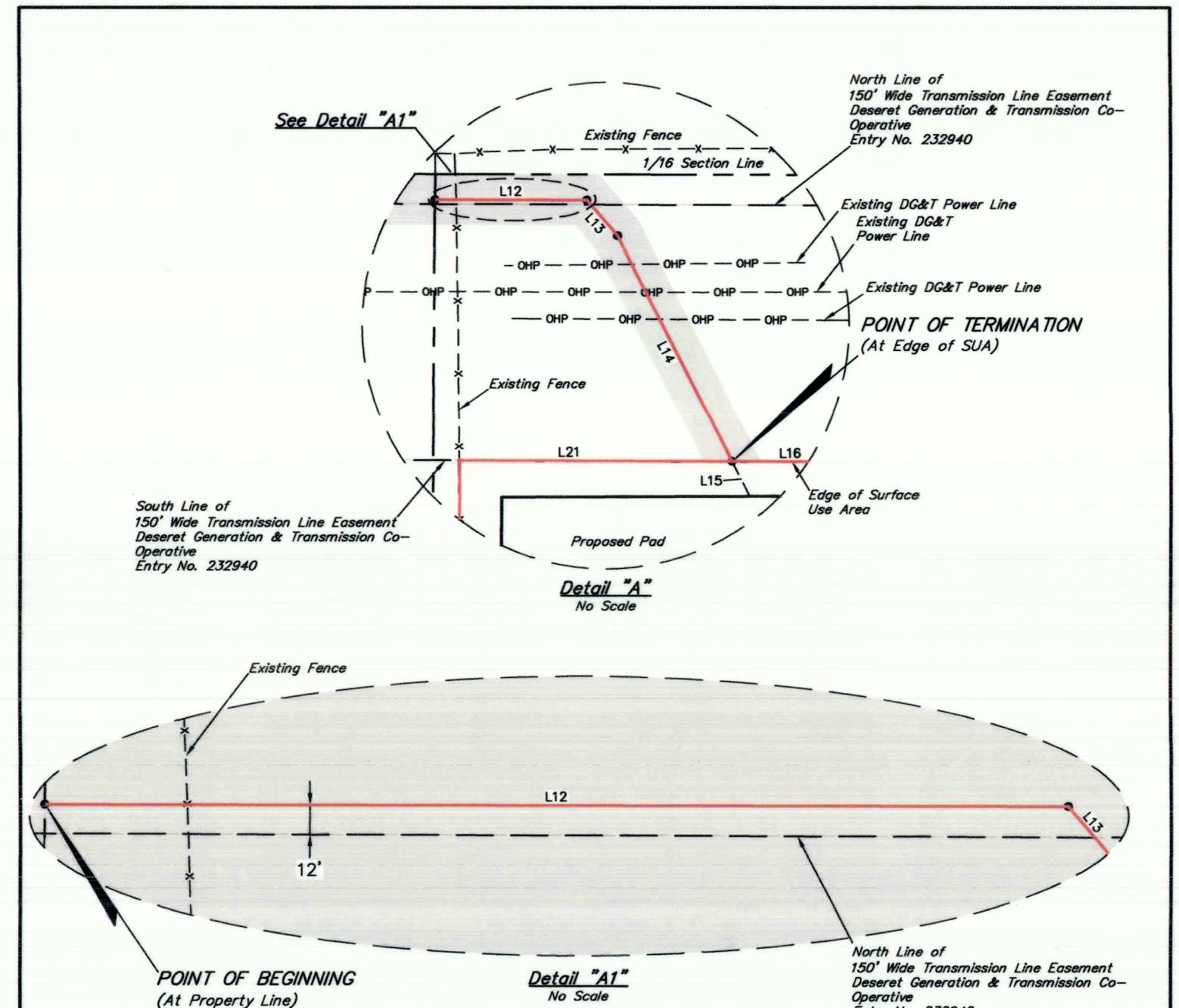

SURFACE USE AREA DESCRIPTION

COMMENCING AT THE NORTHEAST CORNER OF SECTION 34, T2S, R3W, U.S.B.&M.; THENCE S00°38'02"W 2700.59' ALONG THE EAST LINE OF THE NE 1/4 OF SAID SECTION 34 TO THE EAST 1/4 CORNER OF SAID SECTION 34; THENCE N43°39'44"W 1637.40' TO A POINT ON THE SOUTH LINE OF THE DESERET GENERATION & TRANSMISSION CO-OPERATIVE TRANSMISSION LINE EASEMENT IN THE SE 1/4 NE 1/4 OF SAID SECTION 34 AND THE POINT OF BEGINNING; THENCE S89°47'56"E 382.14' ALONG THE SOUTH LINE OF SAID TRANSMISSION LINE EASEMENT; THENCE S00°04'40"W 560.06'; THENCE S86°19'22"W 324.13'; THENCE N66°50'00"W 235.09'; THENCE N00°10'17"W 490.26' TO A POINT ON THE SOUTH LINE OF SAID TRANSMISSION LINE EASEMENT; THENCE S89°47'56"E 159.69' ALONG THE SOUTH LINE OF SAID TRANSMISSION LINE EASEMENT TO THE POINT OF BEGINNING. CONTAINS 6.913 ACRES MORE OR LESS.

CERTIFICATE

THIS IS TO CERTIFY THAT THE ABOVE PLAT WAS PREPARED FROM FIELD NOTES OF ACTUAL SURVEYS MADE BY ME OR UNDER MY SUPERVISION AND THAT THE SAME ARE TRUE AND CORRECT TO THE BEST OF MY KNOWLEDGE AND BELIEF.

Wendell R. Benthon
 REGISTERED LAND SURVEYOR
 REGISTRATION NO. 6631032
 STATE OF UTAH 2012-21

Sheet 2 of 2

REV: 5 04-30-21 L.K. (UPDATE LINE TAGS)

XCL ASSETCO., LLC

**NELSON 34-2D-23 PAD
 ON BRAD LEE NELSON CO TRUSTEE LANDS IN
 SECTION 34, T2S, R3W, U.S.B.&M.
 DUCHESNE COUNTY, UTAH**

SURVEYED BY	C.R.	01-28-21	SCALE
DRAWN BY	S.K.	02-01-21	1" = 500'
FILE	X-1417-C2		

ACCESS ROAD R-O-W & SUA



UELS, LLC
 Corporate Office * 85 South 200 East
 Vernal, UT 84078 * (435) 789-1017

County Surveyor's File # 4933