

ROAD RIGHT-OF-WAY DESCRIPTION

A 30' WIDE RIGHT-OF-WAY 15' ON EACH SIDE OF THE FOLLOWING DESCRIBED CENTERLINE.
 COMMENCING AT THE NORTHWEST CORNER OF SECTION 34, T2S, R3W, U.S.B.&M.; THENCE N89°46'37"E 2637.28' ALONG THE NORTH LINE OF THE NW 1/4 OF SAID SECTION 34 TO THE NORTH 1/4 CORNER OF SAID SECTION 34; THENCE S01°37'28"W 1335.60' TO A POINT ON THE NORTH LINE OF THE SE 1/4 NW 1/4 OF SAID SECTION 34 AND THE POINT OF BEGINNING; THENCE S23°34'54"E 13.60'; THENCE S82°57'21"E 21.10'; THENCE S89°53'36"E 1321.59' TO A POINT ON THE EAST LINE OF THE SW 1/4 NE 1/4 OF SAID SECTION 34 AND THE POINT OF TERMINATION, WHICH BEARS S44°05'10"E 1883.04' FROM THE NORTH 1/4 CORNER OF SAID SECTION 34. THE SIDE LINES OF SAID DESCRIBED RIGHT-OF-WAY BEING SHORTENED OR ELONGATED TO MEET THE GRANTOR'S PROPERTY LINES. CONTAINS 0.934 ACRES MORE OR LESS.

POINT OF BEGINNING BEARS S01°37'28"W 1335.60' FROM THE NORTH 1/4 CORNER OF SECTION 34, T2S, R3W, U.S.B.&M.
 POINT OF TERMINATION BEARS S44°05'10"E 1883.04' FROM THE NORTH 1/4 CORNER OF SECTION 34, T2S, R3W, U.S.B.&M.

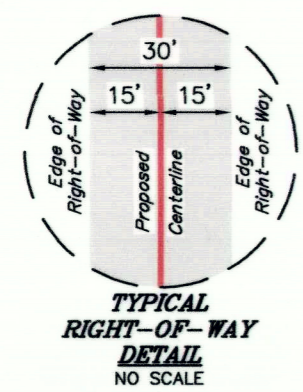

LENGTH & ACREAGE TABLE			
	FEET	RODS	ACRES
ROAD RIGHT-OF-WAY INSIDE OF DG&T EASEMENT	1321.59	80.10	0.421

ACREAGE / LENGTH TABLE		
FEET	RODS	ACRES
1356.29	82.20	0.934

CERTIFICATE
 THIS IS TO CERTIFY THAT THE ABOVE PLAT WAS PREPARED FROM FIELD NOTES OF ACTUAL SURVEYS MADE BY ME OR UNDER MY SUPERVISION AND THAT THE SAME ARE TRUE AND CORRECT TO THE BEST OF MY KNOWLEDGE AND BELIEF.

Brandon R. Borthouse
 REGISTERED LAND SURVEYOR
 REGISTRATION NO. 6631032
 STATE OF UTAH

Sheet 1 of 2
 REV: 5 04-30-21 L.K. (UPDATE LINE TAGS)

XCL ASSETCO., LLC

NELSON 34-2D-23 PAD
 ON LYRAD SHAWN McCONKIE
 (CO TRUSTEE) LANDS IN
 SECTION 34, T2S, R3W, U.S.B.&M.
 DUCHESNE COUNTY, UTAH

SURVEYED BY	C.R.	01-28-21	SCALE
DRAWN BY	S.K.	02-01-21	1" = 500'
FILE	X-1417-B1		

ACCESS ROAD R-O-W & SUA

UJINTAH
 ENGINEERING & LAND SURVEYING

UELS, LLC
 Corporate Office * 85 South 200 East
 Vernal, UT 84078 * (435) 789-1017

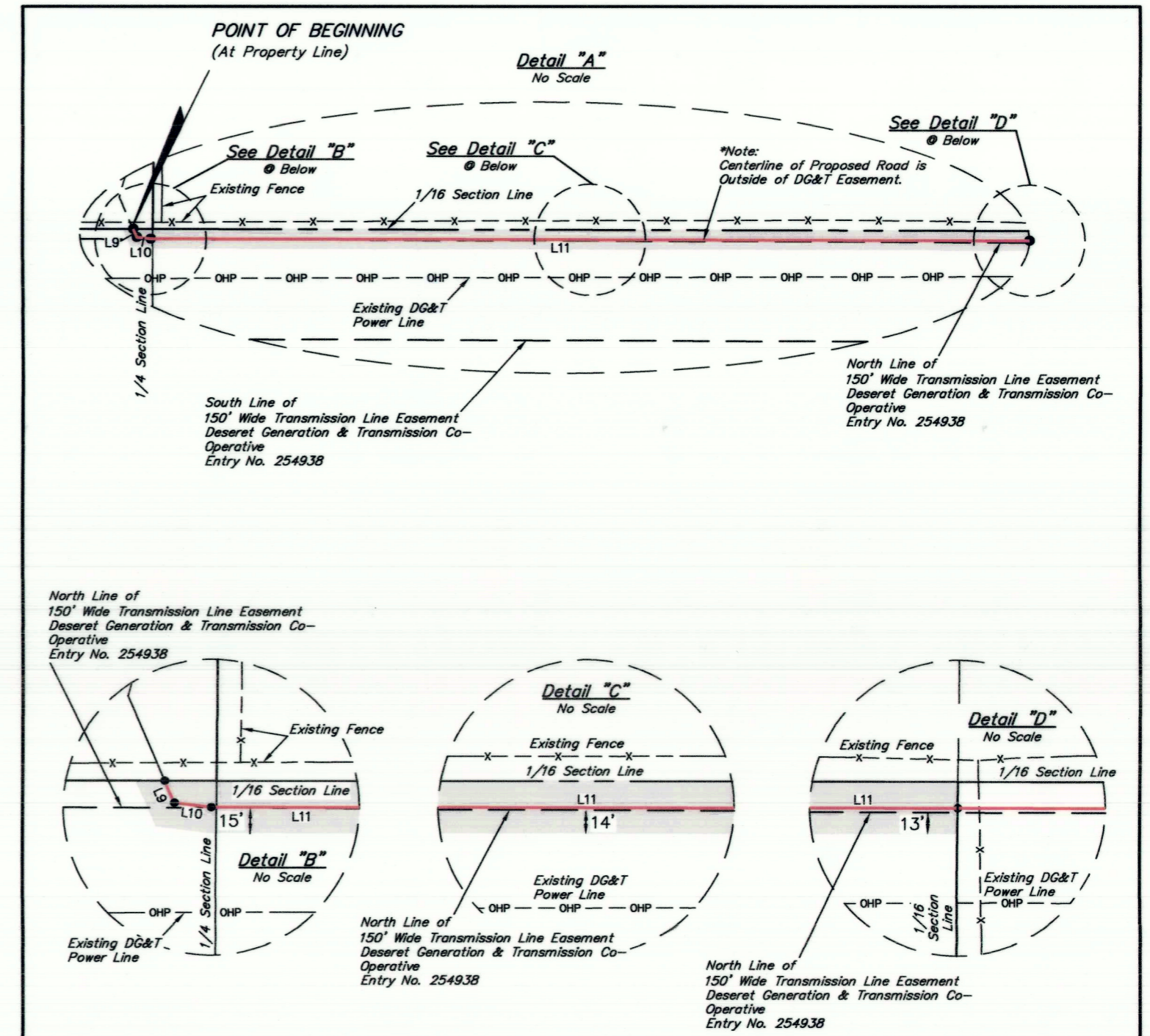

LENGTH & ACREAGE TABLE			
	FEET	RODS	ACRES
ROAD RIGHT-OF-WAY INSIDE OF DG&T EASEMENT	1321.59	80.10	0.421

CERTIFICATE
 THIS IS TO CERTIFY THAT THE ABOVE PLAT WAS PREPARED FROM FIELD NOTES OF ACTUAL SURVEYS MADE BY ME OR UNDER MY SUPERVISION AND THAT THE SAME ARE TRUE AND CORRECT TO THE BEST OF MY KNOWLEDGE AND BELIEF.

Brandon R. Borthouse
 REGISTERED LAND SURVEYOR
 REGISTRATION NO. 6631032
 STATE OF UTAH

Sheet 2 of 2
 REV: 5 04-30-21 L.K. (UPDATE LINE TAGS)

XCL ASSETCO., LLC

NELSON 34-2D-23 PAD
 ON LYRAD SHAWN McCONKIE
 (CO TRUSTEE) LANDS IN
 SECTION 34, T2S, R3W, U.S.B.&M.
 DUCHESNE COUNTY, UTAH

SURVEYED BY	C.R.	01-28-21	SCALE
DRAWN BY	S.K.	02-01-21	1" = 500'
FILE	X-1417-B2		

ACCESS ROAD R-O-W & SUA

UJINTAH
 ENGINEERING & LAND SURVEYING

UELS, LLC
 Corporate Office * 85 South 200 East
 Vernal, UT 84078 * (435) 789-1017

County Surveyor's File # 4932