

LINE TABLE		
LINE	DIRECTION	LENGTH
L116	S05°40'49"E	72.11'
L117	S01°38'49"W	259.58'
L118	S00°20'48"E	795.84'
L119	S04°38'09"E	134.40'
L120	S20°07'23"E	48.52'

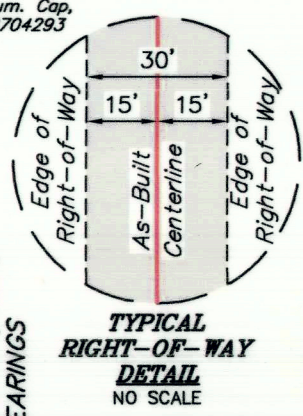

AS-BUILT PIPELINE RIGHT-OF-WAY DESCRIPTION

A 30' WIDE RIGHT-OF-WAY 15' ON EACH SIDE OF THE FOLLOWING DESCRIBED CENTERLINE.
 COMMENCING AT THE EAST 1/4 CORNER OF SECTION 22, T2S, R3W, U.S.B.&M., THENCE S00°02'28"W 2612.70' ALONG THE EAST LINE OF THE SE 1/4 OF SAID SECTION 22 TO THE SOUTHEAST CORNER OF SAID SECTION 22; THENCE S02°15'27"W 1307.08' TO A POINT ON THE NORTH LINE OF THE SE 1/4 SE 1/4 OF SAID SECTION 22 AND THE POINT OF BEGINNING; THENCE S05°40'49"E 72.11'; THENCE S01°38'49"W 259.58'; THENCE S00°20'48"E 795.84'; THENCE S04°38'09"E 134.40'; THENCE S20°07'23"E 48.52' TO A POINT ON THE SOUTH LINE OF THE SE 1/4 SE 1/4 OF SAID SECTION 22 AND THE POINT OF TERMINATION, WHICH BEARS N89°45'42"W 17.57' FROM THE SOUTHEAST CORNER OF SAID SECTION 22. THE SIDE LINES OF SAID DESCRIBED RIGHT-OF-WAY BEING SHORTENED OR ELONGATED TO MEET THE GRANTOR'S PROPERTY LINES. CONTAINS 0.903 ACRES MORE OR LESS.

ACREAGE / LENGTH TABLE		
FEET	RODS	ACRES
1310.45	79.42	0.903



▲ = SECTION CORNERS LOCATED.

CERTIFICATE
 THIS IS TO CERTIFY THAT THE ABOVE PLAT WAS PREPARED FROM FIELD NOTES OF ACTUAL SURVEYS MADE BY ME OR UNDER MY SUPERVISION AND THAT THE SAME ARE TRUE AND CORRECT TO THE BEST OF MY KNOWLEDGE AND BELIEF.
 Brandon Rowthorpe
 REGISTERED LAND SURVEYOR
 REGISTRATION NO. 6631032
 STATE OF UTAH



UELS, LLC
 Corporate Office * 85 South 200 East
 Vernal, UT 84078 * (435) 789-1017



XCL ASSETCO., LLC
 MAIN TRUNK LINE
 AS-BUILT PIPELINE RIGHT-OF-WAY ON
 XCL ASSETCO., LLC LANDS
 SECTION 22, T2S, R3W, U.S.B.&M.
 DUCHESNE COUNTY, UTAH

SURVEYED BY	C.R.	11-05-20	SCALE
DRAWN BY	S.O.	11-12-20	1" = 500'
FILE:	X-1392-Q		

AS-BUILT PIPELINE RIGHT-OF-WAY

County Surveyor's File # 4741