

SE1/4 SW1/4

LAT: 40°18'59.16571" N
LONG: 110°11'25.98249" } NAD 83

22+50.25

PIPELINE TIE-IN

N 85°46'03" W 2809.24'

S 89°47'55" W 5284.09'
TO SECTION CORNER

L18

L15

L13

L17

L16

L14

L12

L11

L10

L9

L7

L8

L6

ACCESS ROAD

L5

L4

L3

L2

SALES UNITS

00+00.00

WELL HEAD

TANK BATTERY

EXISTING WELL PAD

LAT: 40°18'51.14644" N
LONG: 110°11'04.13338" } NAD 83

FOUND B.L.M.
MONUMENT AT
SECTION CORNER

SEC 11 SEC 12
SEC 14 SEC 13

N60°48'43"E
1269.73'

PIPELINE AS-BUILT SURVEY FOR
KINDER MORGAN ALTAMONT, LLC.
COOK 4-14B3
SECTIONS 11 & 14, T2S, R3W, U.S.B.&M..
DUCHEсне COUNTY, UTAH

LINE	BEARING	DISTANCE
L1	N10°06'09"W	125.03'
L2	N22°50'17"W	46.21'
L3	N28°37'46"W	106.03'
L4	N32°00'25"W	100.44'
L5	N28°36'45"W	110.14'
L6	N26°44'45"W	107.09'
L7	N62°25'45"W	39.36'
L8	N81°14'47"W	28.07'
L9	N88°28'52"W	115.02'
L10	S89°41'54"W	496.70'
L11	N89°25'40"W	302.01'
L12	S87°20'17"W	154.83'
L13	S84°07'11"W	76.26'
L14	N82°03'00"W	54.96'
L15	N77°49'14"W	131.96'
L16	N50°36'08"W	68.15'
L17	N15°49'01"W	43.40'
L18	N02°40'00"E	144.59'

NORTH

SCALE: 1"=400'

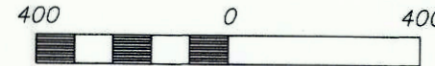

THIS SURVEY WAS PERFORMED USING GLOBAL POSITIONING SYSTEM PROCEDURES AND EQUIPMENT

THE BASIS OF BEARINGS IS GEODETIC NORTH DERIVED FROM G.P.S. OBSERVATIONS AT A CONTROL POINT LOCATED AT LAT. 40°23'18.20359"N AND LONG. 110°10'15.86470"W USING THE UTAH STATE G.P.S. VIRTUAL REFERENCE STATION CONTROL NETWORK MAINTAINED AND OPERATED BY THE AUTOMATED GEOGRAPHIC REFERENCE CENTER

SURVEYOR'S CERTIFICATE

This is to certify that this plat was prepared from the field notes and electronic data collector files of an actual survey made by me, or under my personal supervision, of the pipeline shown hereon, and that this plat accurately represents said survey to the best of my knowledge.

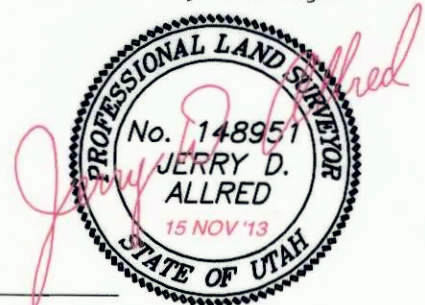

JERRY D. ALLRED, REGISTERED LAND SURVEYOR,
CERTIFICATE NO. 148951 (UTAH)

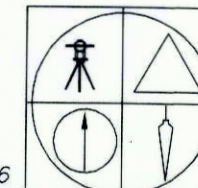

JERRY D. ALLRED AND ASSOCIATES
SURVEYING CONSULTANTS

1235 NORTH 700 EAST--P.O. BOX 975
DUCHEсне, UTAH 84021
(435) 738-5352

NE1/4 NW1/4

NW1/4 NE1/4

NE1/4 NE1/4

TO SECTION CORNER
N 00°10'33" E 5254.65'

15 NOV 2013

12-121-076