

SEC 33 SEC 34
 N 89°54'10" E 2646.29'

SEC 4 SEC 3 COUNTY ROAD

FOUND MONUMENT SPIKE
 AT SECTION CORNER

NE 1/4 NW 1/4
 CONOVER
 PROPERTY

NW 1/4 NW 1/4
 COX
 PROPERTY

BEGINNING PIPELINE STA. 0+00.00
 LAT: 40°20'31.62691" N } NAD 83
 LONG: 110°12'47.03620" W }

S 00°32'55" W 2678.51'

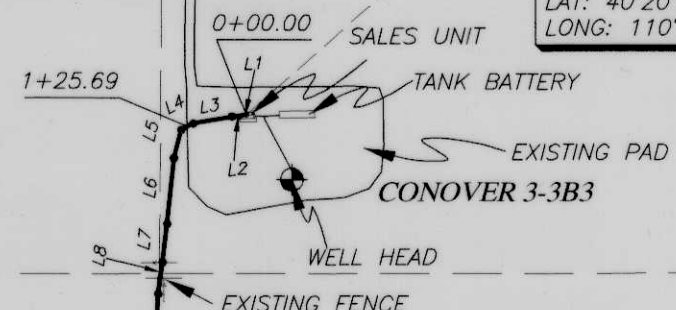

SW 1/4 NW 1/4
 MILES
 PROPERTY

SE 1/4 NW 1/4
 MILES
 PROPERTY

S 89°04'29" W 1339.77'

FOUND MONUMENT
 SPIKE AT 1/4 CORNER

TIE-IN TO
 17+62.35 EXISTING PIPELINE
 ENDING PIPELINE STA. 17+62.35
 LAT: 40°20'15.34523" N } NAD 83
 LONG: 110°12'49.35027" W }

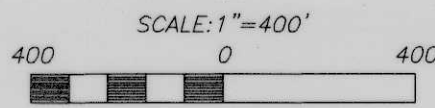
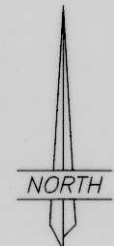

PIPELINE AS-BUILT SURVEY FOR
KINDER MORGAN ALTAMONT, LLC.
CONOVER 3-3B3
 SECTION 3, T2S, R3W, U.S.B.&M.
 DUCHESNE COUNTY, UTAH

LINE	BEARING	DISTANCE
L1	S 87°05'09" W	3.88'
L2	S 82°45'01" W	25.55'
L3	S 79°55'46" W	82.40'
L4	S 61°38'43" W	28.60'
L5	S 14°25'47" W	60.39'
L6	S 05°51'39" W	137.78'
L7	S 06°47'01" W	80.76'
L8	S 07°48'53" W	66.49'
L9	S 02°18'43" W	162.76'
L10	S 01°01'45" E	225.51'
L11	S 00°52'37" E	188.60'
L12	S 00°29'35" W	157.36'
L13	S 01°18'33" E	166.50'
L14	S 00°40'48" E	160.58'
L15	S 00°12'30" E	160.41'
L16	S 06°54'27" W	38.69'
L17	S 19°37'32" E	11.87'
L18	S 06°23'50" E	4.22'

THIS SURVEY WAS PERFORMED USING GLOBAL POSITIONING SYSTEM PROCEDURES AND EQUIPMENT
 THE BASIS OF BEARINGS IS GEODETIC NORTH DERIVED FROM G.P.S. OBSERVATIONS AT A SECTION CORNER LOCATED AT LAT. 40°21'33.56882"N AND LONG. 110°16'31.53266"W USING THE UTAH STATE G.P.S. VIRTUAL REFERENCE STATION CONTROL NETWORK MAINTAINED AND OPERATED BY THE AUTOMATED GEOGRAPHIC REFERENCE CENTER

SURVEYOR'S CERTIFICATE

This is to certify that this plat was prepared from the field notes and electronic data collector files of an actual survey made by me, or under my personal supervision, of the pipeline shown hereon, and that this plat accurately represents said survey to the best of my knowledge.

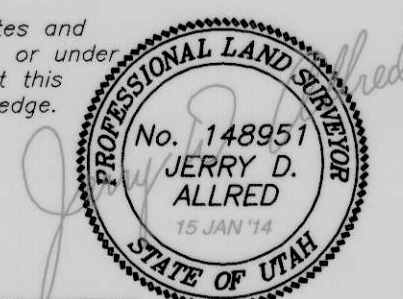

JERRY D. ALLRED, REGISTERED LAND SURVEYOR,
 CERTIFICATE NO. 148951 (UTAH)

COUNTY SURVEYOR'S FILE NUMBER

JERRY D. ALLRED AND ASSOCIATES
 SURVEYING CONSULTANTS
 1235 NORTH 700 EAST--P.O. BOX 975
 DUCHESNE, UTAH 84021
 (435) 738-5352

15 JAN 2014 12-121-122