

L1	N 64°42'32\"	W	127.77'
L2	N 58°32'22\"	W	53.87'
L3	N 55°57'15\"	W	103.30'
L4	N 50°35'42\"	W	108.72'
L5	N 50°04'09\"	W	280.00'
L6	N 51°31'24\"	W	200.94'
L7	N 13°40'15\"	E	389.99'
L8	N 20°13'11\"	E	287.45'
L9	N 10°04'02\"	E	374.09'
L10	N 15°23'23\"	E	314.81'
L11	N 89°59'14\"	E	105.72'
L12	N 79°55'58\"	W	134.15'

LEGEND AND NOTES
 THIS SURVEY WAS PERFORMED USING GLOBAL POSITIONING SYSTEM (G.P.S.) PROCEDURES AND EQUIPMENT. THE BEARINGS ARE BASED ON WGS 84 DATUM.

SURVEYOR'S CERTIFICATE
 This is to certify that I have surveyed the right-of-way parcels shown on this plat, and that the monuments indicated were found or set during said survey, and that this plat accurately represents said survey to the best of my knowledge.

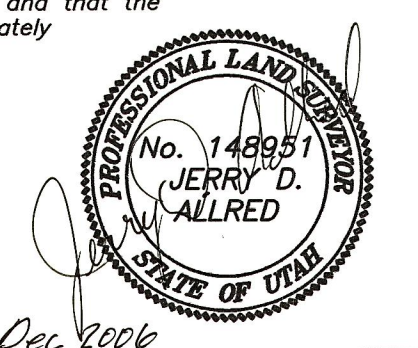

29 Dec 2006
 Jerry D. Allred, Duchesne County Surveyor
 Utah Certificate Number 148951

OWNER'S DEDICATION
 Know all men by these presents: that we the undersigned, warrant ownership of the tracts of land shown hereon, and do hereby dedicate and grant to DUCHESNE COUNTY for construction and maintenance of a County Road these parcels of land shown on this plat as NEW COUNTY ROAD RIGHT-OF-WAY.

Landowner's Signatures _____ Date Acknowledged to Notary _____ Notary's Initials _____

COUNTY COMMISSION ACCEPTANCE
 The dedication and granting of the right-of-way parcel shown on this plat as part of Duchesne County Road Number _____, accepted by the Board of County Commissioners this _____ day of _____, 20____.

Attest: County Clerk _____ Chair _____
 Commissioner _____ Commissioner _____

ACKNOWLEDGMENT
 State of Utah }
 County of Duchesne } ss
 On the dates shown by each signature, personally appeared before me the signers of the above dedication who duly acknowledged to me that they did execute same.
 My commission expires _____
 Notary Public _____

COUNTY RECORDER'S CERTIFICATE
 State of Utah }
 County of Duchesne } ss
 This is to certify that this plat was filed for recording in the County Recorder's office on the _____ day of _____, 20____ at _____ o'clock and is duly recorded.
 Book _____ Page _____
 Filing No. _____ County Recorder _____

**COUNTY ROAD RIGHT-OF-WAY SURVEY FOR
 DUCHESNE COUNTY
 SECTION 16, TOWNSHIP 2 SOUTH, RANGE 1 WEST
 UINTAH SPECIAL BASE AND MERIDIAN**

County Surveyor's File # 1841
JERRY D. ALLRED & ASSOCIATES
 SURVEYING CONSULTANTS
 121 NORTH CENTER ST. - P.O. BOX 975
 DUCHESNE, UTAH 84021
 (435) 738-5352