

RECORD OF SURVEY OF AN AGRICULTURAL  
MINOR SUBDIVISION FOR  
**LUKE DEFA**

SECTION 11, TOWNSHIP 1 SOUTH, RANGE 8  
WEST UTAH SPECIAL BASE AND MERIDIAN  
DUCHESE COUNTY, UTAH

DESCRIPTION OF BOUNDARY

Commencing at the Northwest Corner of the SW1/4 of the SW1/4 of Section 11, Township 1 South, Range 8 West, Utah Special Base and Meridian;  
Thence South 89°47'18" East 415.07 feet along the North line of the South 1/2 of said SW1/4 to the TRUE POINT OF BEGINNING;  
Thence South 89°47'18" East 2209.51 feet along said North line to the Northeast Corner of said S1/2;  
Thence South 00°12'11" West 662.34 feet to the Southeast Corner of the North 1/2 of the SE1/4 of the SW1/4;  
Thence North 89°46'35" West 1311.28 feet to the Southeast Corner of said North 1/2 of the SE1/4 of the SW1/4;  
Thence South 00°06'57" West 353.91 feet along the East line of the SW1/4 to an existing fence;  
Thence North 89°50'56" West 331.56 feet along said fence to the Northerly right-of-way line of State Road 35;  
Thence North 46°08'06" West 773.63 feet along said right-of-way;  
Thence North 43°48'09" East 208.71 feet;  
Thence North 46°08'34" West 208.65 feet;  
Thence North 00°02'46" East 187.12 feet to the TRUE POINT OF BEGINNING, containing 36.84 acres.

OWNER'S CERTIFICATE

We, LARRY DEFA AND SHEILA DEFA, TRUSTEES OF THE LARRY DEFA TRUST AND THE SHEILA DEFA TRUST DATED the 19th day of December, 2012, the undersigned, owners of the parcels of land shown hereon, having caused the same to be subdivided into the parcels as shown, do hereby set apart the same as an Agricultural Minor Subdivision, and place the boundary lines of the parcels as shown and described on this plat.

Landowner's Signatures \_\_\_\_\_ Date Acknowledged \_\_\_\_\_ Notary's Initials \_\_\_\_\_  
to Notary

RODNEY LUKE DEFA, Trustee of the Larry Defa Trust dated the 19th day of December, 2012 and amended the 30th of July 2024.

RODNEY LUKE DEFA, Trustee of the Sheila Defa Trust dated the 19th day of December, 2012 and amended the 30th of July 2024.

ACKNOWLEDGMENT

State of Utah }  
County of Duchesne } SS  
On the date shown by the signature, personally appeared before me LARRY DEFA AND SHEILA DEFA, TRUSTEES OF THE LARRY DEFA TRUST AND THE SHEILA DEFA TRUST DATED the 19th day of December, 2012, the signers of the above certificate who duly acknowledged to me that he did execute same.

My commission expires \_\_\_\_\_ Notary Public \_\_\_\_\_

DUCHESE COUNTY TREASURER \_\_\_\_\_ DUCHESE COUNTY PLANNING DEPARTMENT APPROVAL  
PROPERTY TAX CLEARANCE APPROVED AS AN AGRICULTURAL MINOR SUBDIVISION ON  
THIS \_\_\_\_\_ DAY OF \_\_\_\_\_ OF 20\_\_\_\_ THIS \_\_\_\_\_ DAY OF \_\_\_\_\_ OF 20\_\_\_\_

STEPHEN POTTER \_\_\_\_\_ DUCHESE COUNTY COMMUNITY DEVELOPMENT DIRECTOR  
DUCHESE COUNTY TREASURER

SURVEYOR'S CERTIFICATE

This is to certify that this plat was prepared from the field notes and electronic data collector files of an actual survey made by me, or under my personal supervision, of the parcel of land shown hereon, and that the monuments indicated were found or set during said survey, and that this plat accurately represents said survey to the best of my knowledge.

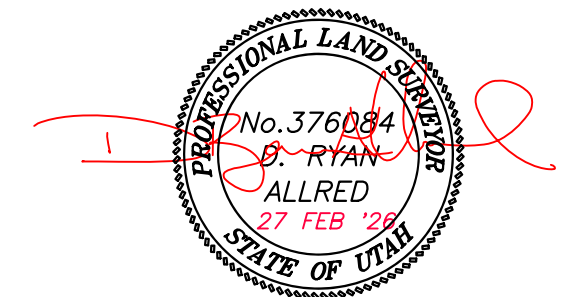

D. Ryan Allred, Professional Land Surveyor, Certificate No. 376084 (Utah)

COUNTY RECORDER'S CERTIFICATE

STATE OF UTAH }  
COUNTY OF DUCHESE } SS  
THIS IS TO CERTIFY THAT THIS PLAT WAS FILED FOR RECORD IN THE COUNTY RECORDER'S OFFICE ON THE  
\_\_\_\_\_ DAY OF \_\_\_\_\_, 20\_\_\_\_, AT \_\_\_\_\_ O'CLOCK \_\_\_\_\_ M, AND IS DULY RECORDED.

ENTRY NO. \_\_\_\_\_ COUNTY RECORDER \_\_\_\_\_

COUNTY SURVEYOR FILE NO. 6117

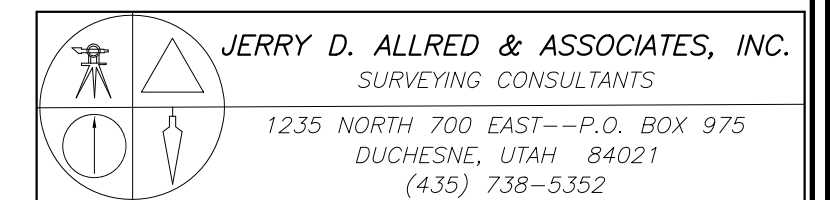

27 FEB 2026 26-100-027

POSITION OF 1/4 CORNER DETERMINED FROM SURVEY AS FILE #2295 (DUCHESE COUNTY SURVEYOR'S OFFICE) WHICH USED TIES OFF OF THE ROBERT'S ROOST SUBDIVISION PLAT, SET 5/8"x24" REBAR WITH 2 1/2" DUCHESE COUNTY ALUM. AND REFERENCES

FOUND G.L.O. 2 1/2" BRASS CAP ON STEEL PIPE AT 1/4 CORNER

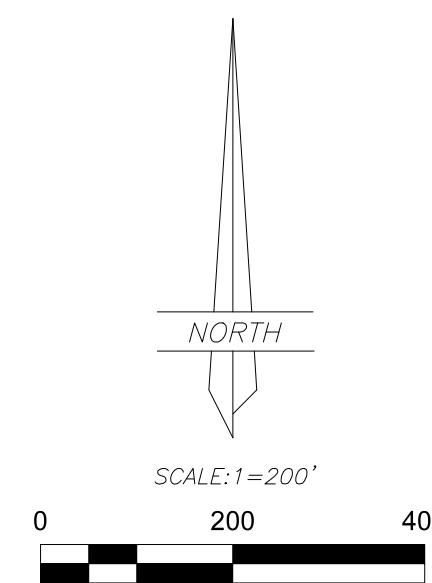

BASIS OF BEARINGS

This survey was performed using G.P.S. (Global Positioning System) equipment and procedures. The basis of bearings for this survey is a bearing of NORTH 89°46'15" WEST with a distance of 1310.57' from the Southwest Section Corner to the Southeast Corner of the SW1/4 of the SW1/4 of Section 11 derived from G.P.S. observations using the Utah State G.P.S. virtual reference station control network maintained and operated by the Utah Geospatial Resource center.

NARRATIVE

This survey was performed at the request of Luke Defa for the purpose of creating an Agricultural Minor Subdivision of the land shown on this plat. A search was made for the monuments marking the public lands survey system corners needed for this survey and the results are noted on the plat. This plat represents a dependent resurvey of portions of Section 11, and is designed to restore the aliquot part corners to their true original locations according to the best available evidence. The corners found or reestablished were used to control the survey.

LEGEND AND NOTES

- ⊕ MONUMENTS FOUND A SECTION CORNERS USED BY THIS SURVEY
- ⊙ MONUMENTS FOUND AT THE QUARTER CORNER USED BY THIS SURVEY
- FOUND MONUMENT SPIKE SET BY OTHERS PRIOR TO APRIL 1988
- SET 5/8"x24" REBAR WITH PLASTIC CAP STAMPED ALLRED SURVEYING
- x- EXISTING FENCE
- ◆ FOUND HIGHWAY RIGHT-OF-WAY MON. USED TO CALCULATE IT'S POSITION

