

FOUND PEATROSS REBAR AT QUARTER CORNER

S 89°27'03" W 2650.67'

FOUND B.L.M. PIPE AND CAP AT SECTION CORNER SEC 25, SEC 30
SEC 36 SEC 31

S 76°06'59" W 4230.51'

N 59°32'46" W 2529.91' (MEASURED)
N 59°32'46" W 2528.39' (FROM PLAT)

S 80°24'17" W 2653.24' (BASIS OF BEARINGS)

FOUND B.L.M. PIPE AND CAP AT QUARTER CORNER

LINE	BEARING	DISTANCE
L10	S 83°52'13" E	139.94'
L11	S 00°02'42" W	149.17'
L12	N 83°34'48" W	57.05'
L13	N 23°27'44" W	171.14'

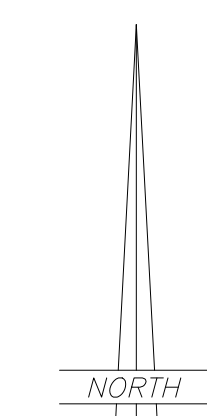

SCALE: 1"=200'

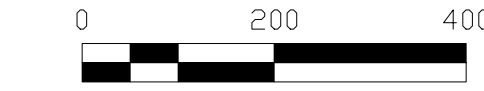

MONUMENTS FOUND AND TIED IN

- | PT# | DESCRIPTION |
|-----|---|
| 1 | REBAR WITH WOODEN STAKE |
| 2 | WOODEN HUB |
| 3 | POST |
| 4 | 1/2" REBAR WITH LATH |
| 5 | CLINT PEATROSS REBAR |
| 6 | IRON PIPE IN CONCRETE CYLINDER |
| 7 | ANGLE IRON PEG WITH WOODEN HUB |
| 8 | ANGLE IRON PEG |
| 9 | RODNEY ROWLEY REBAR |
| 10 | RODNEY ROWLEY REBAR |
| 11 | FENCE CORNER POST |
| 12 | 5/8" REBAR |
| 13 | 5/8" REBAR |
| 14 | 5/8" REBAR |
| 15 | 5/8" REBAR |
| 16 | 5/8" REBAR |
| 17 | 5/8" REBAR |
| 18 | 5/8" REBAR |
| 19 | WOODEN HUB |
| 20 | 5/8" REBAR |
| 21 | 5/8" REBAR |
| 22 | 5/8" REBAR |
| 23 | 5/8" REBAR |
| 24 | 5/8" REBAR |
| 25 | 5/8" REBAR |
| 26 | 5/8" REBAR |
| 27 | IRON ROD |
| 28 | 5/8" REBAR AT FENCE CORNER |
| 29 | 5/8" REBAR AT FENCE CORNER |
| 30 | 5/8" REBAR |
| 31 | 5/8" REBAR AT FENCE CORNER |
| 32 | 5/8" REBAR AT FENCE CORNER |
| 33 | 1/2" REBAR |
| 34 | 5/8" REBAR |
| 35 | 5/8" REBAR |
| 36 | 5/8" REBAR |
| 37 | FENCE CORNER POST |
| 38 | POST |
| 39 | 5/8" REBAR |
| 40 | 5/8" REBAR |
| 41 | 5/8" REBAR |
| 42 | 5/8" REBAR |
| 43 | STEEL ROD |
| 44 | WOODEN HUB |
| 45 | 1" DIAMETER IRON PIPE |
| 46 | 6" DIAMETER CONCRETE COLUMN |
| 47 | WOODEN HUB |
| 48 | 5/8" REBAR |
| 49 | UPROOTED 12" SPIKE |
| 50 | WOODEN HUB |
| 51 | FENCE CORNER ON EXTENSION OF LINE |
| 52 | FENCE CORNER ON EXTENSION OF LINE |
| 53 | FENCE CORNER ON EXTENSION OF LINE |
| 54 | FENCE CORNER ON EXTENSION OF LINE |
| 55 | FENCE CORNER WITH DELINEATOR POST ALONGSIDE |
| 56 | FENCE CORNER |

LINE	BEARING	DISTANCE
L1	N 09°42'00" E	233.40'
L2	S 89°27'15" E	153.89'
L3	S 49°02'50" E	32.83'
L4	S 21°57'24" W	116.19'
L5	S 23°52'15" E	72.72'
L6	S 71°12'54" W	213.65'
L7	S 09°42'00" W	109.83'
L8	S 81°50'05" E	165.58'
L9	S 81°25'09" E	99.83'

LEGEND AND NOTES

- FOUND SECTION CORNERS AS DESCRIBED ON PLAT ON PREVIOUS SURVEYS
- FOUND QUARTER CORNERS AS DESCRIBED ON PLAT ON PREVIOUS SURVEYS
- FOUND VARIOUS MONUMENTS AT OR NEAR LOT CORNERS; SEE COLUMN AT RIGHT
- FOUND 5/8"x24" REBAR USED TO CONTROL THIS SURVEY
- FOUND ORIGINAL HUB LYING ON GROUND NEXT TO METAL SIGN POST AT LOT CORNER
- SET 5/8"x24" REBAR WITH PLASTIC CAP STAMPED "ALLRED SURVEYING" AT LOT CORNERS
- EXISTING FENCES

NARRATIVE

This survey was performed at the request of Jeff Womack for the purpose of marking on the ground the corners of his lot as shown on this plat. MT. TABBY SPRINGS SUBDIVISION, in all of its phases, was surveyed and staked in the 1960's. In searching for original lots corners as part of this survey, as well as previous surveys done in this area, many different kinds of monuments were found and tied in. These monuments are listed in the MONUMENTS FOUND AND TIED IN table. The accuracy of the placement of the lot corners on the original survey was very poor. The best equipment available for use at the time was a transit or theodolite, and a steel tape. Given the steep and irregular terrain and the thick vegetation cover we felt fortunate to find the monuments shown. The data on the subdivision plats was plotted and it was found that the ties to the General Land Office monuments shown on the plats differed from each other and none of which fit the found monuments as part of this survey. A reasonably close fit for distance, as calculated from the data derived from the plats (2528.39 feet), and the distance measured on the ground by this survey (2529.91 feet), was found between the monuments found at numbers 1 and 23. The plotted configuration of the lots, from the plats, was rotated to fit this calibration line. The difference between these two values is 1.52 feet (a precision of 1/1664). Using this rotation the location of the remaining corners for Mr. Womack's lot were found or calculated from the data shown on the subdivision plat and rebar set as noted.

PROPERTY SURVEY FOR
JEFF WOMACK
 LOT 1, PLAT "1", MOUNT TABBY SPRINGS SUBDIVISION.
 SECTION 36, TOWNSHIP 1 SOUTH, RANGE 8 WEST
 UTAH SPECIAL BASE AND MERIDIAN

SURVEYOR'S CERTIFICATE

I, Jerry D. Allred, do hereby certify that I am a Professional Land Surveyor, and that I hold certificate no. 148951 as prescribed by the laws of the State of Utah. I further certify that this plat and its computations were prepared from the field notes and electronic data collector files of an actual survey made by me, or under my personal supervision, of the parcels of land shown hereon, and that the monuments indicated were found or set during said survey, and that this plat accurately represents said survey to the best of my knowledge.

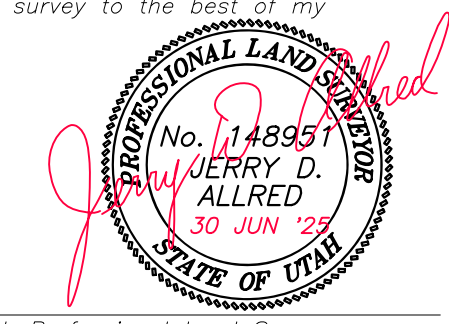

Jerry D. Allred, Professional Land Surveyor,
 Certificate 148951 (Utah)

COUNTY SURVEYOR FILE NO. 5936

JERRY D. ALLRED & ASSOCIATES, INC.
 SURVEYING CONSULTANTS
 1235 NORTH 700 EAST—P.O. BOX 975
 DUCHESNE, UTAH 84021
 (435) 738-5352