

RECORD OF SURVEY FOR
DOUG JESSOP
 OF
LOT 1, PRICE MINOR SUBDIVISION
 SECTION 10, TOWNSHIP 1 SOUTH, RANGE 8 WEST
 UINTAH SPECIAL BASE AND MERIDIAN

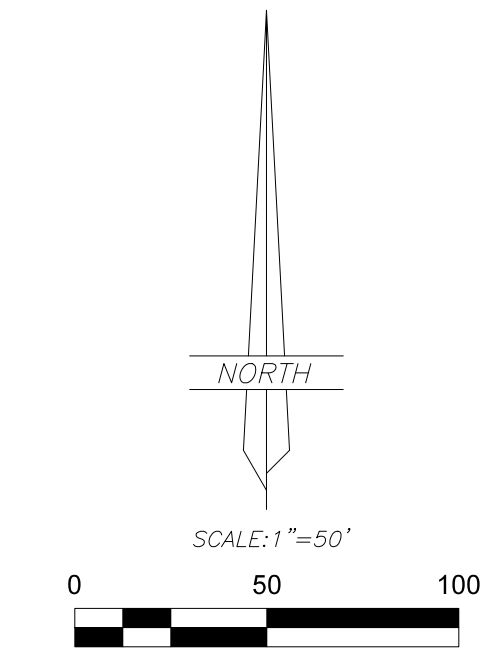

- LEGEND**
- FOUND OR SET SECTION CORNER AS NOTED ON PLAT
 - FOUND OR SET QUARTER CORNER AS NOTED ON PLAT
 - ◇ FOUND OR SET 1/16 CORNER AS NOTED ON PLAT
 - ◇ FOUND REBAR SET ON PREVIOUS SURVEY
 - ▲ FOUND "T" BAR SET ON LINE ON PREVIOUS SURVEY
 - FOUND NAIL AND WASHER IN FENCE POST SET ON PREVIOUS SURVEY
 - FOUND FENCE POST AS PROPERTY CORNER
 - SET 5/8"x24" REBAR WITH PLASTIC CAP STAMPED "ALLRED SURVEY"
 - x - x - EXISTING FENCE

BASIS OF BEARINGS

THIS SURVEY WAS PERFORMED USING GLOBAL POSITIONING SYSTEM (G.P.S.) EQUIPMENT AND PROCEDURES USING THE UTAH G.P.S. VIRTUAL REFERENCE STATION CONTROL NETWORK MAINTAINED AND OPERATED BY THE UTAH GEOSPATIAL RESOURCE CENTER. THE BASIS OF BEARINGS IS GEODETIC NORTH DERIVED FROM G.P.S. OBSERVATIONS AT A CONTROL POINT LOCATED AT LAT: 40°24'48.32741" N & LONG: 110°47'28.45814" W USING SAD CONTROL NETWORK.

NARRATIVE

This survey was performed at the request of Doug Jessop for the purpose of locating on the ground the corners of Lot 1 of the PRICE MINOR SUBDIVISION as shown on this plat. The monuments marking the Public Land Survey System corners were found as noted and used to control the survey. The data from the original subdivision plat, recorded in March 2015, was plotted and related to the basis of bearings of this survey. The highway plats, for the part of Utah State Road #25 which goes through Hanna, were used to plot the highway centerline and right-of-way lines. This data was also related to the basis of bearing for this survey. A search was then made to locate the corners of Lot 1. The original subdivision plat shows that the two Lot corners along the highway right-of-way line were fence corner posts. These posts were found by this survey and used to fix the front of the lot. The subdivision plat also shows that the back lot corners were marked with 5/8"x24 rebar. The monuments marking these corners could not be found, they had been replaced with fence corner posts. These posts were located and tied in as representing the positions of the back corners of Lot 1.

SURVEYOR'S CERTIFICATE

I, Jerry D. Allred, do hereby certify that I am a Professional Land Surveyor, and that I hold certificate no. 148951 as prescribed by the laws of the State of Utah. I further certify that this plat and its computations were prepared from the field notes and electronic data collector files of an actual survey made by me, or under my personal supervision, of the parcels of land shown hereon, and that the monuments indicated were found or set during said survey, and that this plat accurately represents said survey to the best of my knowledge.

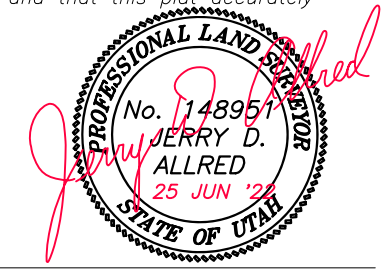

JERRY D. ALLRED, PROFESSIONAL LAND SURVEYOR
 CERTIFICATE NO. 148951 (UTAH)

COUNTY SURVEYOR FILE NO. 5209

JERRY D. ALLRED & ASSOCIATES, INC.
 SURVEYING CONSULTANTS
 1235 NORTH 700 EAST—P.O. BOX 975
 DUCHESNE, UTAH 84021
 (435) 738-5352



FOUND COUNTY MONUMENT AT SECTION CORNER
 SEC 10 SEC 11
 SEC 15 SEC 14