

LEGEND AND BASIS OF BEARINGS

- FOUND MONUMENT AS NOTED AT SECTION CORNERS
- FOUND MONUMENT AS NOTED AT QUARTER CORNER
- FOUND 1/2" REBAR AT OR NEAR LOT CORNERS
- SET 5/8"x24" REBAR WITH PLASTIC CAP STAMPED "ALLRED SURVEYING"

THIS SURVEY WAS PERFORMED USING G.P.S. (GLOBAL POSITIONING SYSTEM) EQUIPMENT AND PROCEDURES. THE BASIS OF BEARINGS IS BASED ON WGS-84 GEODETIC NORTH AT THE CORNER COMMON TO SECTIONS 1, 2, 11, AND 12, TOWNSHIP 1 SOUTH, RANGE 8 WEST OF THE UTAH SPECIAL BASE AND MERIDIAN AS DETERMINED BY THE UTAH STATE GPS VIRTUAL REFERENCE STATION CONTROL NETWORK MAINTAINED AND OPERATED BY THE AUTOMATED GEOGRAPHIC REFERENCE CENTER

NARRATIVE AND NOTES

This survey was performed at the request of Ginger Casper for the purpose of locating on the ground the corners of Lots 32-37 of ROBERTS' ROOST SUBDIVISION. A search was made for the monuments marking the Public Land Survey System corners which control the location of the subdivision. The results are noted on the plot. All lot corner monuments from the original staking of the subdivision were also searched for. Those monuments found within one foot of the record position as determined from the subdivision plat were accepted and used and those that exceeded that limit were reset as part of this survey as shown in the following notes. Those who's position exceeds the limit seem to not be original corners but set by subsequent surveys and do not meet the standard of being an original monument.

- ① FOUND 1/2" REBAR AT CLOSING LOT CORNER 0.38 FEET SOUTH OF LINE
- ② FOUND 1/2" REBAR AT CLOSING LOT CORNER 0.24 FEET SOUTH OF LINE
- ③ FOUND 1/2" REBAR AT CLOSING LOT CORNER 0.28 FEET SOUTH OF LINE
- ④ FOUND 1/2" REBAR AT CLOSING LOT CORNER 0.62 FEET SOUTH OF LINE
- ⑤ FOUND 1/2" REBAR AT CLOSING LOT CORNER 0.63 FEET WEST OF LINE
- ⑥ FOUND 1/2" REBAR SOUTH 1.12 FEET AND WEST 4.76 FEET FROM LOT CORNER—TOO FAR OUT OF POSITION AND NOT USED BY THIS SURVEY
- ⑦ FOUND 1/2" REBAR SOUTH 1.48 FEET AND WEST 1.56 FEET FROM LOT CORNER—TOO FAR OUT OF POSITION AND NOT USED BY THIS SURVEY
- ⑧ FOUND 1/2" REBAR NORTH 2.09 FEET AND EAST 4.43 FEET FROM LOT CORNER—TOO FAR OUT OF POSITION AND NOT USED BY THIS SURVEY
- ⑨ FOUND 1/2" REBAR SOUTH 0.32 FEET AND WEST 1.29 FEET FROM LOT CORNER—TOO FAR OUT OF POSITION AND NOT USED BY THIS SURVEY

FOUND DUCHESNE COUNTY ALUMINUM CAP AT QUARTER CORNER
N 89°55'44" W 2639.17'

FOUND DUCHESNE COUNTY ALUMINUM CAP AT SECTION CORNER

SEC 11 SEC 12
SEC 14 SEC 13

N 00°07'51" E 5306.75'

RECORD OF SURVEY FOR
GINGER CASPER

LOTS 32, 33, 34, 35, 36, & 37
ROBERT'S ROOST SUBDIVISION

SECTION 1, TOWNSHIP 1 SOUTH, RANGE 8 WEST
UINTAH SPECIAL BASE AND MERIDIAN

SURVEYOR'S CERTIFICATE

I, Jerry D. Allred, do hereby certify that I am a Professional Land Surveyor, and that I hold certificate no. 148951 as prescribed by the laws of the State of Utah. I further certify that this plat and its computations were prepared from the field notes and electronic data collector files of an actual survey made by me, or under my personal supervision, of the parcels of land shown hereon, and that the monuments indicated were found or set during said survey, and that this plat accurately represents said survey to the best of my knowledge.

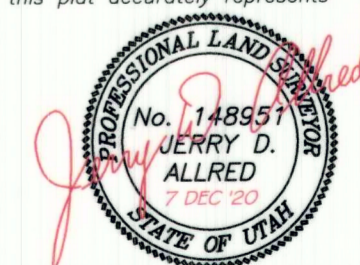

JERRY D. ALLRED, PROFESSIONAL LAND SURVEYOR
CERTIFICATE NO. 148951 (UTAH)

COUNTY SURVEYOR FILE NO. **4699**

JERRY D. ALLRED & ASSOCIATES, INC.
SURVEYING CONSULTANTS
1235 NORTH 700 EAST—P.O. BOX 975
DUCHESE, UTAH 84021
(435) 738-5352