

DRAWING NUMBER

DRAWING NUMBER
4323

DRAWING NUMBER

DRAWING NUMBER

RECORD OF SURVEY FOR ROB JAHRIES

SECTIONS 10, 11, 14, AND 15, TOWNSHIP 1 SOUTH, RANGE 8 WEST UINTAH SPECIAL BASE AND MERIDIAN

DESCRIPTION OF PARCEL IN SECTION 10
Beginning at the Southeast Corner of Section 10, Township 1 South, Range 8 West of the Uintah Special Base and Meridian;
Thence South 89°54'38" West 400.26 feet along the South line of the SE¼ of said Section to an existing fence;
Thence the following eight courses along said fence and extension thereof:
North 17°33'33" West 325.41 feet;
North 11°57'03" East 59.46 feet;
North 41°13'37" East 18.32 feet;
North 46°58'23" East 157.60 feet;
North 37°05'39" East 32.35 feet;
North 24°58'51" East 12.35 feet;
North 36°22'24" East 45.80 feet;
North 18°15'39" West 108.22 feet, more or less to the centerline of the Duchesne River;
Thence South Southeasterly 423 feet, more or less along said centerline to the East line of said aliquot part;
Thence South 0°02'29" West 426.72 feet along said West line to the Point of Beginning, containing 5.247 acres.

DESCRIPTION OF PARCEL IN SECTION 11
Beginning at the Southwest Corner of Section 11, Township 1 South, Range 8 West of the Uintah Special Base and Meridian;
Thence North 0°02'29" East 426.72 feet, more or less along the West line of the SW¼ of the SW¼ of said Section to the centerline of the Duchesne River;
Thence Southeasterly 843 feet, more or less along said centerline to the South line of said aliquot part;
Thence North 89°46'15" West 669.80 feet along said South line to the Point of Beginning, containing 4.599 acres.

DESCRIPTION OF PARCEL IN SECTION 15
The Northeast Quarter of the Northeast Quarter of Section 15, Township 1 South, Range 8 West of the Uintah Special Base and Meridian, containing 40.206 acres

DESCRIPTIONS OF PARCELS IN SECTION 14
Beginning at the Northwest Corner of the NW¼ of the NW¼ of Section 14, Township 1 South, Range 8 West of the Uintah Special Base and Meridian;
Thence South 89°46'15" East 669.80 feet along the North line of said aliquot part to the centerline of the Duchesne River;
Thence Southeasterly 1029 feet, more or less along said centerline to the West line of said aliquot part;
Thence North 0°07'51" East 667.68 feet to the Southeast Corner of said aliquot part;
Thence North 89°57'56" West 1305.88 feet to the Southwest Corner of said aliquot part;
Thence North 0°19'52" West 1536.07 feet along the West line of said aliquot part to the Point of Beginning, containing 33.599 acres.

NW¼ NW¼ The Southwest Quarter of the Northwest Quarter of Section 14, Township 1 South, Range 8 West of the Uintah Special Base and Meridian, containing 39.914 acres.

Beginning at the Southwest Corner of the Southeast Quarter of the Northwest Quarter of Section 14, Township 1 South, Range 8 West of the Uintah Special Base and Meridian;
Thence North 0°07'51" West 1331.52 feet to the Northwest Corner of said aliquot part;
Thence South 89°57'56" East 188.87 feet, more or less along the North line of said aliquot part to the centerline of the Duchesne River;
Thence Southeasterly 875 feet, more or less along said centerline to the extension of an existing fence;
Thence South 32°50'32" West 200.04 feet along said fence and extension thereof;
Thence South 29°02'28" West 158.07 feet along said fence;
Thence South 29°03'56" West 407.84 feet along said fence;
Thence South 29°03'56" West 260.56 feet along said fence and extension thereof to the South line of said aliquot part;
Thence South 89°50'55" West 167.63 feet along said South line to the Point of Beginning, containing 12.349 acres.

LINK	BEARING	DISTANCE
L1	N 77°33'33" W	325.41
L2	N 11°57'03" E	59.46
L3	N 41°13'37" E	18.32
L4	N 46°58'23" E	157.60
L5	N 37°05'39" E	32.35
L6	N 24°58'51" E	12.35
L7	N 36°22'24" E	45.80
L8	N 18°15'39" W	108.22
L9	S 0°02'29" W	426.72
L10	S 29°03'56" W	158.07
L11	S 29°03'56" W	407.84
L12	S 29°03'56" W	260.56

- LEGEND AND NOTES**
- ⊕ FOUND SECTION CORNERS
 - ⊕ FOUND QUARTER CORNERS
 - ◆ FOUND OR SET ALIQUOT PART CORNERS AS NOTED ON PLAT
 - FOUND FENCE CORNERS OR POSTS
 - FOUND REBAR SET BY PREVIOUS SURVEYS
 - SET 5/8"x24" REBAR WITH PLASTIC CAP STAMPED "ALLRED SURVEYING"
 - ⚡ FOUND HIGHWAY RIGHT-OF-WAY MARKERS
 - FOUND TREE AT PROPERTY CORNER
 - ▼ SPIKES WITH "WHISKERS" SET ON LINE WITH LATH ALONGSIDE

NARRATIVE
This survey was performed at the request of Rob Jarchie for the purpose of locating the lines and corners of the parcel shown on this plat. The monuments marking the Public Land Survey System corners were found as indicated and used to control the survey. A standard section subdivision was performed using the found monuments to determine the position of the aliquot parts boundaries.

SURVEYOR'S CERTIFICATE

I, Jerry D. Allred, do hereby certify that I am a Professional Land Surveyor, and that I hold certificate no. 148951 as prescribed by the laws of the State of Utah; I further certify that this plat and its computations were prepared from the field notes and electronic data collector files of an actual survey made by me, or under my personal supervision, of the parcels of land shown hereon, and that the monuments indicated were found or set during said survey, and that this plat accurately represents said survey to the best of my knowledge.

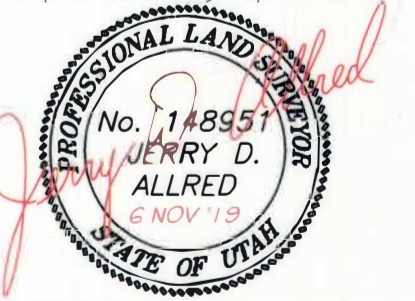

JERRY D. ALLRED, PROFESSIONAL LAND SURVEYOR
CERTIFICATE NO. 148951 (UIAH)

COUNTY SURVEYOR FILE NO. **4323**
JERRY D. ALLRED & ASSOCIATES, INC.
SURVEYING CONSULTANTS
1235 NORTH 700 EAST—P.O. BOX 975
DUCHESE, UTAH 84021
(435) 738-5352