

RECORD OF SURVEY OF
LOT 33 EQUESTRIAN ESTATES SUBDIVISION
 FOR
CORY SMITH

SECTION 16, TOWNSHIP 2 SOUTH, RANGE 3 WEST
 UTAH SPECIAL BASE AND MERIDIAN
 DUCHESNE COUNTY, UTAH

ORIGINAL DESCRIPTION

WARRANTY DEED
 ENTRY NO. 579412

LOT 33, EQUESTRIAN ESTATES SUBDIVISION, according to the official plat thereof on file at the County Recorder's Office.

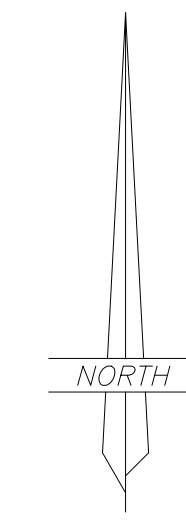

SCALE: 1=200'



LEGEND

- FOUND OR SET SECTION CORNER AS NOTED ON PLAT
- FOUND OR SET QUARTER CORNER AS NOTED ON PLAT
- FOUND OR SET 1/16 CORNER AS NOTED ON PLAT
- FOUND MONUMENT SET BY OTHERS
- SET 5/8"x24" REBAR WITH PLASTIC CAP STAMPED "ALLRED SURVEY"
- ▼ 8" SPIKES WITH "WHISKERS" SET ON LINE
- FENCE CORNER
- x- EXISTING FENCE
- ⊙ MAG SPIKE AND WASHER
- △ FOUND 1/2" REBAR AS ORIGINAL LOT CORNER MONUMENT
- ⊕ FOUND CULINARY WATER METER (UPPER COUNTRY WATER DISTRICT)
- ⊕ FOUND TELEPHONE PEDESTAL (STRATA NETWORKS)
- ⊕ FOUND POWER POLE (MOON LAKE ELECTRIC ASSN)
- - - FOUND OVERHEAD POWER LINE

BASIS OF BEARINGS

THIS SURVEY WAS PERFORMED BY USING G.P.S. (GLOBAL POSITIONING SYSTEM) EQUIPMENT AND PROCEDURES.

THE BASIS OF BEARINGS FOR THIS SURVEY IS A BEARING OF N 00°09'06" W FROM THE SOUTHWEST SECTION CORNER TO THE WEST 1/4 CORNER BETWEEN SECTIONS 16 AND 17 DERIVED FROM G.P.S. OBSERVATIONS USING THE UTAH STATE G.P.S. VERTICAL REFERENCE STATION CONTROL NETWORK MAINTAINED AND OPERATED BY THE UTAH GEOSPATIAL RESOURCE CENTER.

NARRATIVE

This survey was performed at the request of Cory Smith locating and marking the corners and lines of Lot 33 of EQUESTRIAN ESTATES SUBDIVISION, as shown on this plat. Using the original subdivision plat a search was made to find any monuments marking these lot corners needed to control this survey. Several monuments were found as noted on the plat. This survey used the found monuments to determine the position of those missing corners and to flag the lines connecting the corners.

SURVEYOR'S CERTIFICATE

I, Jerry D. Allred, do hereby certify that I am a Professional Land Surveyor, and that I hold certificate no. 148951 as prescribed by the laws of the State of Utah. I further certify that this plat and its computations were prepared from the field notes and electronic data collector files of an actual survey made by me, or under my personal supervision, of the parcels of land shown hereon, and that the monuments indicated were found or set during said survey, and that this plat accurately represents said survey to the best of my knowledge.

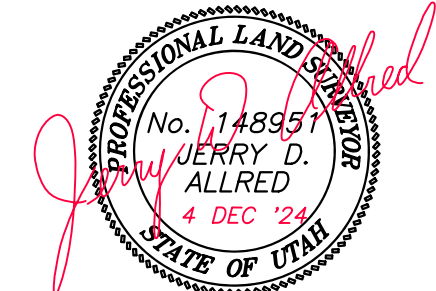

Jerry D. Allred, Professional Land Surveyor
 Utah Certificate Number 148951

COUNTY SURVEYOR FILE NO. **5820**
JERRY D. ALLRED & ASSOCIATES, INC.
 SURVEYING CONSULTANTS
 1235 NORTH 700 EAST—P.O. BOX 975
 DUCHESNE, UTAH 84021
 (435) 738-5352

