

RECORD OF SURVEY FOR JENNIFER TRAPP

SECTION 28, TOWNSHIP 3 SOUTH, RANGE 8 WEST
UINTAH SPECIAL BASE AND MERIDIAN
DUCHESE COUNTY, UTAH

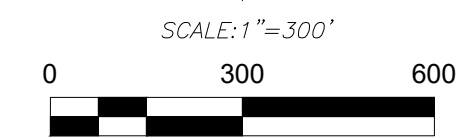
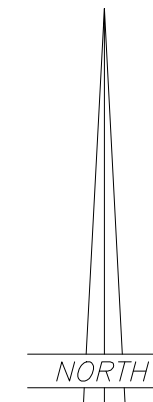

LEGEND

- FOUND OR SET SECTION CORNER AS NOTED ON PLAT
- FOUND OR SET QUARTER CORNER AS NOTED ON PLAT
- FOUND OR SET 1/16 CORNER AS NOTED ON PLAT
- FOUND MONUMENT SET BY OTHERS
- SET 5/8"x24" REBAR WITH PLASTIC CAP STAMPED "ALLRED SURVEY"
- 8" SPIKES WITH "WHISKERS" SET ON LINE
- FENCE CORNER
- EXISTING FENCE
- MAG SPIKE AND WASHER
- FOUND ORIGINAL 1/8" REBAR LOT CORNERS

BASIS OF BEARINGS

THIS SURVEY WAS PERFORMED USING GLOBAL POSITIONING SYSTEM (G.P.S.) EQUIPMENT AND PROCEDURES USING THE UTAH G.P.S. VIRTUAL REFERENCE STATION CONTROL NETWORK MAINTAINED AND OPERATED BY THE UTAH GEOSPATIAL RESOURCE CENTER. THE BASIS OF BEARINGS IS GEODETIC NORTH DERIVED FROM G.P.S. OBSERVATIONS AT A CONTROL POINT (SECTION CORNER) LOCATED AT LAT: 40°09'16.01931" N & LONG: 110°45'51.61780" W USING SAID CONTROL NETWORK.

NARRATIVE

This survey was performed at the request of Jennifer Trapp for the purpose of finding and/or monumenting the corners of the 5/8" of LOT 29, RED CREEK RANCHES SUBDIVISION. The subdivision was created by Martin Moore in 1982 and was plotted without benefit of using the quarter corners of Section 28. The lots as plotted are therefore not strictly equivalent to the aliquot part lines of the section. The monuments set at the time of plating, and not the aliquot part lines, control the position of the lots on the ground. A search was made for the monuments marking the several corners and the results are noted on this plat. These found lot corner monuments were used to control the survey.

SURVEYOR'S CERTIFICATE

I, Jerry D. Allred, do hereby certify that I am a Professional Land Surveyor, and that I hold certificate no. 148951 as prescribed by the laws of the State of Utah. I further certify that this plat and its computations were prepared from the field notes and electronic data collector files of an actual survey made by me, or under my personal supervision, of the parcels of land shown hereon, and that the monuments indicated were found or set during said survey, and that this plat accurately represents said survey to the best of my knowledge.

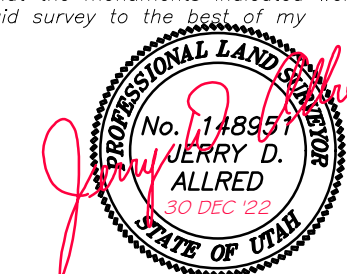

JERRY D. ALLRED, PROFESSIONAL LAND SURVEYOR
CERTIFICATE NO. 148951 (UTAH)

COUNTY SURVEYOR FILE NO. 5382

JERRY D. ALLRED & ASSOCIATES, INC.
SURVEYING CONSULTANTS
1235 NORTH 700 EAST—P.O. BOX 975
DUCHESE, UTAH 84021
(435) 738-5332



FOUND PK NAIL IN ORIGINAL "X" CHISELED IN LARGE BOULDER AT SECTION CORNER

FOUND 2 1/2" ALUMINUM COUNTY MONUMENT AT 1/4 CORNER

FOUND DUCHESE COUNTY MONUMENT AT SECTION CORNER

THE POSITIONS OF THE LOT LINES ARE DETERMINED BY THE ORIGINAL LOT CORNER MONUMENTS AND ARE NOT COINCIDENT WITH THE ALIQUOT PART LINES

FOUND ORIGINAL 1/2" REBAR LOT CORNER

FOUND ROLLED IRON PIN AS IS CUSTOMARY IN SUBDIVISION IN THIS AREA THAT WERE SURVEYED ORIGINALLY BY MARTIN MOORE

FOUND 1/2" REBAR WITH PLASTIC CAP IN PLOTTED IRON PIN (CUSTOMARY IN SUBDIVISION IN THIS AREA THAT WERE SURVEYED ORIGINALLY BY MARTIN MOORE)

FOUND DUCHESE COUNTY 2 1/2" DIA. ALUMINUM CAP AND PIPE MONUMENT AT 1/4 CORNER

FOUND 5/8" REBAR WITH 1 1/2" ALUMINUM CAP WITH T-POST ALONGSIDE AT 1/4 CORNER

FOUND DUCHESE COUNTY MONUMENT AT SECTION CORNER

FOUND DUCHESE COUNTY 2 1/2" DIA. ALUMINUM CAP AND PIPE MONUMENT AT SECTION CORNER

NOT FOUND