

**RECORD OF SURVEY FOR  
BEN HENDERSON**

**LOT 14, SUNDANCE WEST-UNIT B  
AND PART OF SECTION 17, TOWNSHIP 2 SOUTH, RANGE 4 WEST  
UINTAH SPECIAL BASE AND MERIDIAN**

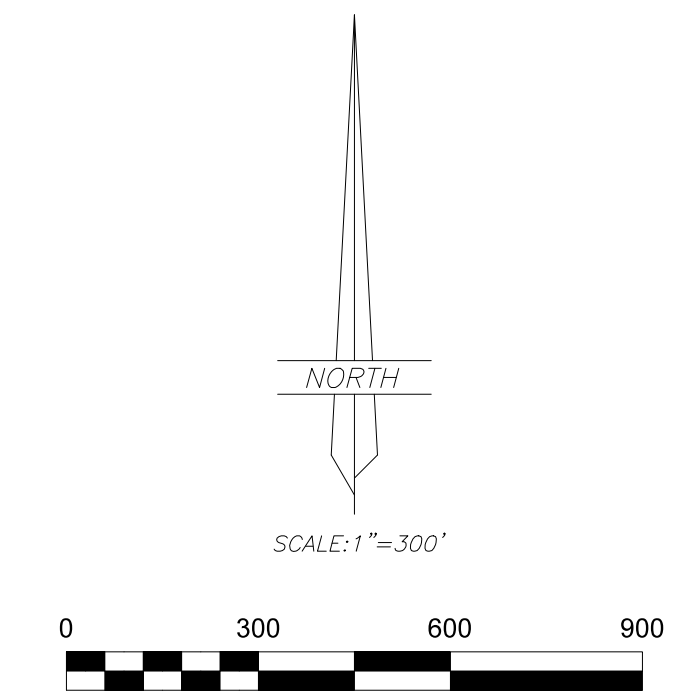

LEGEND	
	FOUND OR SET SECTION CORNER AS NOTED ON PLAT
	FOUND OR SET QUARTER CORNER AS NOTED ON PLAT
	FOUND OR SET 1/16 CORNER AS NOTED ON PLAT
	FOUND ORIGINAL LOT CORNER MONUMENTS
	5/8"x24" REBAR WITH PLASTIC CAP STAMPED "ALLRED SURVEY"
	8" SPIKES WITH "WHISKERS" SET ON LINE

**NARRATIVE**

This survey was performed at the request of Ben Henderson for the purpose of recovering the corners of Lot 14, SUNDANCE WEST-UNIT B and his additional property adjacent to Lot 14. A search was made for the monuments marking these corners and the results are indicated on the plat. The corners of the Public Land Survey System were found and used to control the survey. The relationship of the subdivision corners to the PLSS corners was determined from the data shown on the plat. The lot corners were then found or set.

**SURVEYOR'S CERTIFICATE**

I, Jerry D. Allred, do hereby certify that I am a Professional Land Surveyor, and that I hold certificate no. 148951 as prescribed by the laws of the State of Utah; I further certify that this plat and its computations were prepared from the field notes and electronic data collector files of an actual survey made by me, or under my personal supervision, of the parcels of land shown hereon, and that the monuments indicated were found or set during said survey, and that this plat accurately represents said survey to the best of my knowledge.

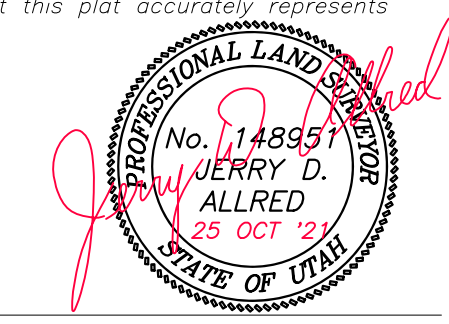

JERRY D. ALLRED, PROFESSIONAL LAND SURVEYOR  
CERTIFICATE NO. 148951 (UTAH)

