

RECORD OF SURVEY FOR
VALERIE HIEBERT-HART
 CEDAR VIEW PROPERTIES
 LOT 37, UNIT 3-PHASE 2

LOCATED IN SECTION 8
 TOWNSHIP 2 SOUTH, RANGE 2 WEST
 UTAH SPECIAL BASE AND MERIDIAN
 DUCHESNE COUNTY, UTAH

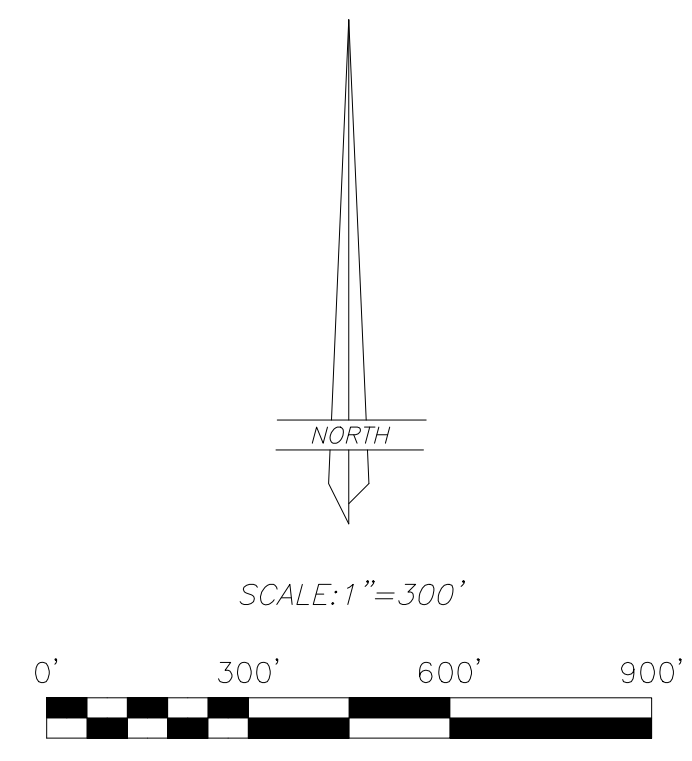

- LEGEND**
- FOUND OR SET SECTION CORNER AS NOTED ON PLAT
 - FOUND OR SET QUARTER CORNER AS NOTED ON PLAT
 - FOUND OR SET 1/16 CORNER AS NOTED ON PLAT
 - FOUND MONUMENT SET BY OTHERS
 - SET 5/8"x24" REBAR WITH PLASTIC CAP STAMPED "ALLRED SURVEY"
 - ▼ 8" SPIKES WITH "WHISKERS" SET ON LINE
 - FENCE CORNER
 - EXISTING FENCE
 - SET FLAGGED LATH ALONGSIDE FOUND SPIKES SET ON LINE

SURVEYOR'S CERTIFICATE

I, Jerry D. Allred, do hereby certify that I am a Professional Land Surveyor, and that I hold certificate no. 148951 as prescribed by the laws of the State of Utah. I further certify that this plat and its computations were prepared from the field notes and electronic data collector files of an actual survey made by me, or under my personal supervision, of the parcels of land shown hereon, and that the monuments indicated were found or set during said survey, and that this plat accurately represents said survey to the best of my knowledge.

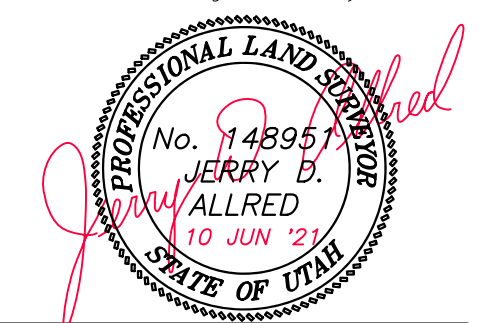

Jerry D. Allred, Professional Land Surveyor,
 Certificate No. 148951 (Utah)

NARRATIVE

This survey was performed at the request of Valerie Hiebert-Hart for the purpose of finding and marking the corners and lines of Lot 37, CEDAR VIEW PROPERTIES, UNIT 3, PHASE 2 as shown on this plat. The monuments marking the Public Land Survey System corners around parts of Section 8 were found as indicated and used to control the survey. Additional control corners were found and used and are noted on the plat.

BASIS OF BEARINGS

THIS SURVEY WAS PERFORMED BY USING G.P.S. (GLOBAL POSITIONING SYSTEM) EQUIPMENT AND PROCEDURES. THE BASIS OF BEARINGS FOR THIS SURVEY IS A BEARING OF N 89°42'42" E FROM THE WEST 1/4 CORNER TO THE EAST 1/4 CORNER DERIVED FROM G.P.S. OBSERVATIONS USING THE UTAH STATE G.P.S. VIRTUAL REFERENCE STATION CONTROL NETWORK MAINTAINED AND OPERATED BY THE AUTOMATED GEOGRAPHIC REFERENCE CENTER.

