

- Legend**
- Existing Manhole
 - Existing Catch Basin
 - ▽ Existing Fire Hydrant & Valve
 - ⊕ Existing Valve
 - Existing Waterline
 - Existing Storm Drain
 - Existing Sanitary Sewer
 - Existing Gas Main
 - Existing Curb & Gutter
 - Existing Sidewalk
 - Existing 8" Conc. Wall
 - Existing Asphalt Paving
 - Existing Concrete
 - Existing power pole
 - Existing powerline
 - Existing railroad tracks
 - Existing Building
 - Existing Sump

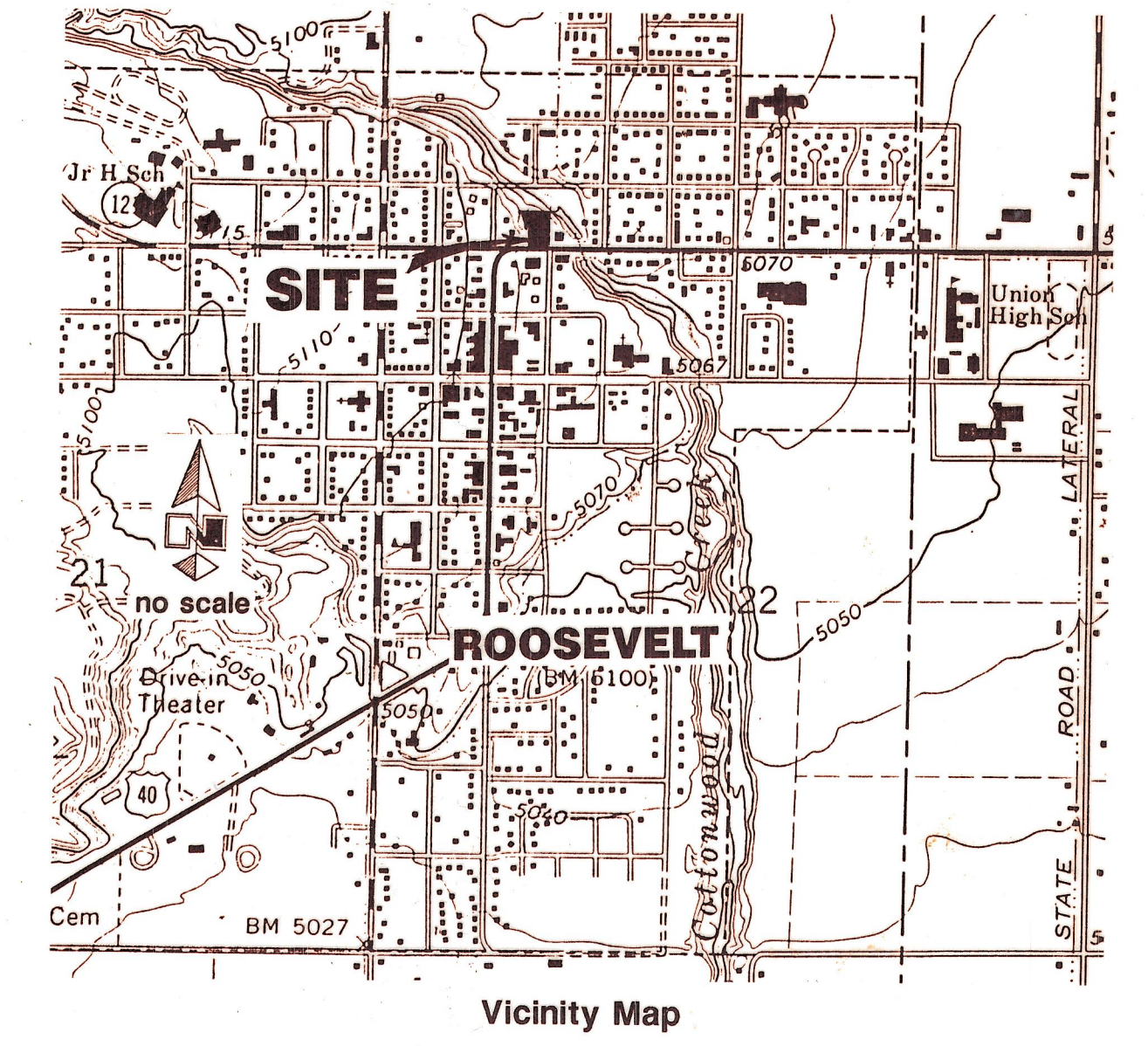

OLD DESCRIPTION

A part of Block 1, Plat "C", Roosevelt City Survey, County of Duchesne, State of Utah

Beginning at a point 50 feet West of the Southern Corner of Lot 1, thence West 214.5 feet; thence North 400 feet; thence East 214.5 feet; thence South 400 feet to the point of beginning.

ALSO, that portion of Lots 4, 5 and 6 of said Block 1 described as follows: Beginning at a point 20 feet North of the Southwest Corner of Lot 6, thence East 114.35 feet; thence South 17°25' East 125.77 feet to the Southeast Corner of Lot 4; thence North to the Northeast Corner of Lot 6; thence West to the Northwest Corner of Lot 6; thence South to the point of beginning.

Excluded Parcel "A"

Less, the following described property: Beginning at a point 50 feet West and 220 feet North of the Southeast Corner of Lot 1, Plat "C", Roosevelt City Survey thence West 214.5 feet; thence North 180 feet; thence East 214.5 feet; thence South 180 feet to the point of beginning.

Excluded Parcel "B"

ALSO THAT PORTION OF Lot 6, Block 1, Plat "C", Roosevelt City Survey described as follows: Beginning at a point 20 feet North of the Southwest Corner of Lot 6, thence East to the East line of said Lot 6; thence North to the Northeast Corner of said Lot 6; thence to the Northwest Corner of said Lot 6; thence South to the point of beginning.

TOGETHER WITH that portion of vacated alley adjoining said lots as vacated in Ordinance No. 88-223 recorded May 9, 1988 as Entry No. 265752 in Book A170, Page 600.

REMAINING AREA CONTAINS 1.144 ACRES

NEW DESCRIPTION

A part of Lots 1, 4, 5, 6 and a portion of the vacated alley in Block 1, Plat C, Roosevelt City Survey, Duchesne County, Utah;

Beginning at the Southwest Corner of said Lot 1; running thence North 200.00 feet along the East line of said Alley; thence West 20.00 feet to the West line of said Alley; thence South 100.00 feet to the Southeast Corner of said Lot 4; thence North 17°25'09" West 125.77 feet to a point 20.00 feet North of the South line of said Lot 6; thence East 272.15 feet; thence South 220.00 feet to the North line of 2nd North Street; thence West 214.50 feet along said North line to the point of beginning.

CONTAINS 1.144 ACRES

CERTIFICATE

To Lawyers Title Insurance Corporation, Western Dairymen Cooperative, Inc., Cream O' Weber Dairy, Inc., a Utah Corporation, and Dean Foods Company, a Delaware Corporation:

This is to certify that this map or plat and the survey of the boundary and improvements within the boundary of the above described property was made in accordance with the "Minimum Standard Detail Requirements for ALTA/ACSM Land Title Surveys" jointly established and adopted by ALTA and ACSM in 1988; meets the accuracy requirements of a Class A Survey, as defined therein, and includes Items 1, 2, 3, 4, 5, 7, 9, 10 and 11 of Table 3 thereof.

Date *5-3-91* By *Gary L. Newman*

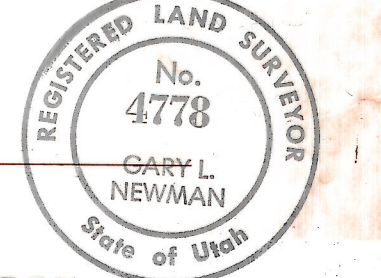

Roosevelt, Utah

GREAT BASIN ENGINEERING, INC.
CONSULTING ENGINEERS & SURVEYORS
OGDEN & SALT LAKE CITY, UTAH

Certificate of Survey for Western Dairymen Cooperative, Inc.

A part of the SW 1/4 of Section 15, T2S, R1W, Uintah Special B&M

DRAWN	DATE	CHECKED	SCALE	APPROVED	DRAWING NO.
CAO	20 March 1991		1" = 30'		

Note:

Item 4, Table 3, additional Survey Requirements for ALTA Land Title Surveys related to flood plain designation. At this time there is no FEMA designation for this property because area has not been mapped; but evidence at the site would indicate that the Northeast Corner of the Property is within a flood plain. (See Drawing)

Item 7, Table 3, additional Survey Requirements for ALTA Land Title Surveys was responded to verbally by Mr. Roger Eschler, Roosevelt City Planner indicating that the Building meets all Zoning Requirements; but has serious concerns related to Building Code.

Narrative

This Survey was requested by Western Dairymen Cooperative Inc., for the purpose of establishing property corners and tying down improvements on the property. Brass cap monuments were found at the Southwest and South Quarter Corner of Section 15. A line bearing East between these two monuments was used as the basis of bearings. Property Corners were monumented with 24" rebar and Great Basin Engineering cap along with a metal fence post marking the location.