

RECORD OF SURVEY OF
RIGHT-OF-WAY EASEMENTS FOR
JON WILKERSON

LOTS 21 AND 22, STRAWBERRY EAST SUBDIVISION
SECTION 1, TOWNSHIP 4 SOUTH, RANGE 5 WEST
UINTAH SPECIAL BASE AND MERIDIAN

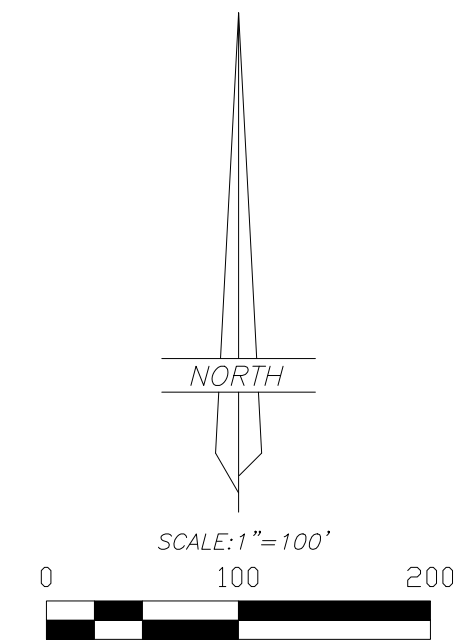

- LEGEND**
- FOUND OR SET SECTION CORNER AS NOTED ON PLAT
 - FOUND OR SET QUARTER CORNER AS NOTED ON PLAT
 - FOUND OR SET 1/16 CORNER AS NOTED ON PLAT
 - FOUND MONUMENT SET BY OTHERS
 - SET 5/8"x24" REBAR WITH PLASTIC CAP STAMPED "ALLRED SURVEY"
 - 8" SPIKES WITH "WHISKERS" SET ON LINE
 - FENCE CORNER
 - EXISTING FENCE
 - MAG SPIKE AND WASHER

BASIS OF BEARINGS

THIS SURVEY WAS PERFORMED USING GLOBAL POSITIONING SYSTEM PROCEDURES AND EQUIPMENT.

THE BASIS OF BEARINGS IS GEODETIC NORTH DERIVED FROM G.P.S. OBSERVATIONS AT A CONTROL POINT LOCATED AT LAT. 40°10'43.26237"N AND LONG. 110°23'52.06157"W USING THE UTAH STATE G.P.S. VIRTUAL REFERENCE STATION CONTROL NETWORK MAINTAINED AND OPERATED BY THE UTAH GEOSPATIAL RESOURCE CENTER

NARRATIVE

This survey was performed at the request of Jon Wilkerson for the purpose of setting the corners of the right-of-way easements on the East end of Bruce V. Smith Lane in the STRAWBERRY EAST SUBDIVISION. The monuments marking the Public Land Survey System corners were found as indicated and used to control the survey. The street centerlines were first established and monumented. The easements described in Warranty Deed Entry No. 204712 were then staked on the ground using 8" monument spikes with "whiskers" as indicated set flush with the ground to avoid damage to tires that from time to time go over the corners.

SURVEYOR'S CERTIFICATE

I, Jerry D. Allred, do hereby certify that I am a Professional Land Surveyor, and that I hold certificate no. 148951 as prescribed by the laws of the State of Utah; I further certify that this plat and its computations were prepared from the field notes and electronic data collector files of an actual survey made by me, or under my personal supervision, of the parcels of land shown hereon, and that the monuments indicated were found or set during said survey, and that this plat accurately represents said survey to the best of my knowledge.

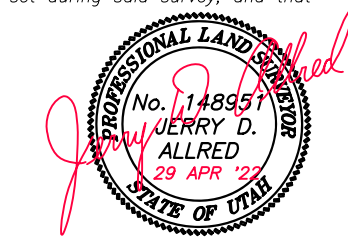

JERRY D. ALLRED, PROFESSIONAL LAND SURVEYOR
CERTIFICATE NO. 148951 (UTAH)

COUNTY SURVEYOR FILE NO. 5097

JERRY D. ALLRED & ASSOCIATES, INC.
SURVEYING CONSULTANTS
1235 NORTH 700 EAST--P.O. BOX 975
DUCHESTER, UTAH 84021
(435) 738-5352

